

CITY OF WORCESTER, MASSACHUSETTS

VARIOUS STREETS 2026 SEWER REHABILITATION PROJECT

DEPARTMENT OF PUBLIC WORKS

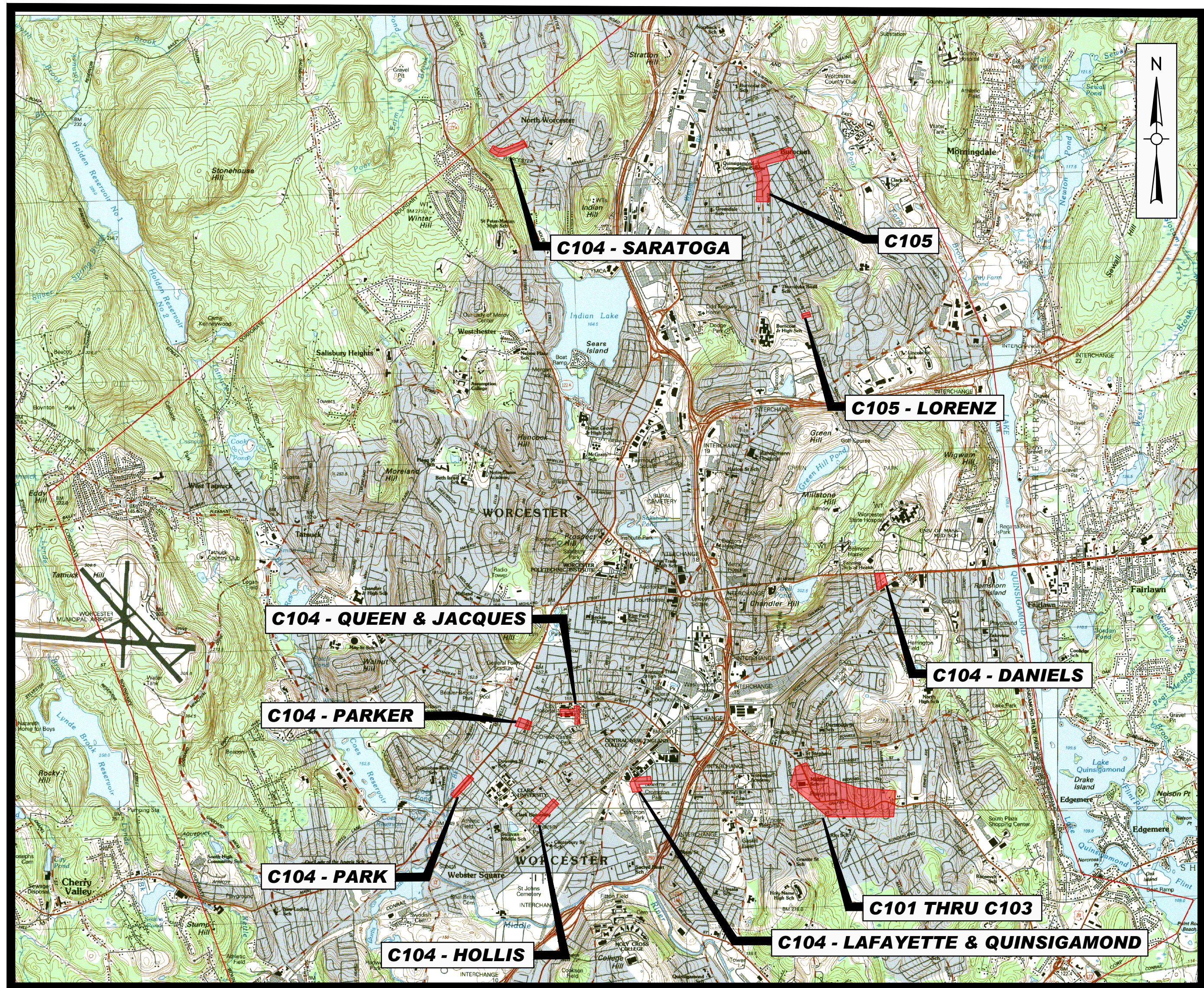

LOCUS MAP
SCALE: 1" = 3,000'

DRAWING INDEX	
SHEET	TITLE
G000	COVER AND DRAWING INDEX
G001	ABBREVIATIONS, NOTES, AND LEGEND
C101	PLANS AND TABLES
C102	PLANS AND TABLES
C103	PLANS AND TABLES
C104	PLANS AND TABLES
C105	PLANS AND TABLES
C501	CONSTRUCTION DETAILS
C502	CITY OF WORCESTER STANDARD CONSTRUCTION DETAILS SHEET 1 OF 2
C503	CITY OF WORCESTER STANDARD CONSTRUCTION DETAILS SHEET 2 OF 2
C504	CONSTRUCTION ZONE SAFETY PLAN



Weston & Sampson Engineers, Inc.
427 Main Street, Suite 400
Worcester, MA 01608
978.532.1900 800.SAMPSON
www.westonandsampson.com

CONTRACT NO. S26-2
BID NO. 8721-M6



ERIC D. BATISTA, CITY MANAGER
JOHN K. WESTERLING, COMMISSIONER OF PUBLIC WORKS

Issued Date:

JUNE 2026



Know what's below.
Call before you dig.

Issued For:

RELEASED FOR CONSTRUCTION

STRUCTURAL CURED-IN-PLACE PIPE								
ASSET ID	MH	TO MH	TYPE	STREET/LOCATION	PIPE DIA (IN)	MATERIAL	APPROXIMATE MH TO MH LENGTH (LF)	REINSTATE ACTIVE SVC. (APPROX. STA)
SM08410	SS05826	SS14232	SANITARY	GRAFTON STREET	8	VC	12	-
SM11609 ¹	SS14232	SS15126	SANITARY	GRAFTON STREET	8	VCP	252	1+39, 1+76, 2+17
SM13529	SS15126	SS15127	SANITARY	FARRAR AVENUE	8	VCP	261	0+35, 0+85, 0+88, 1+67, 1+97
SM12780 ¹	SS15126	SS12723	SANITARY	GRAFTON STREET	8	VCP	293	0+62, 0+88, 1+01, 2+16
SM17592	SS12831	SS12723	SANITARY	GRAFTON STREET	8	VCP	15	-
SM13048 ¹	SS12723	SS13712	SANITARY	GRAFTON STREET	8	VCP	271	0+50, 0+82, 1+00, 2+06
SM12788	SS12724	SS13712	SANITARY	WARNER AVENUE	8	VCP	48	-
SM11708	SS13711	SS13712	SANITARY	WARNER AVENUE	8	VCP	31	-
SM11434 ¹	SS13712	SS14847	SANITARY	GRAFTON STREET	10	VCP	221	0+36, 0+38, 0+89, 0+97, 1+05, 1+61, 1+72
							APPROX. TOTAL (LF) = 1,404	APPROX. TOTAL NUMBER OF SERVICES = 23
							APPROX. 8-INCH TOTAL (LF) = 1,183	
							APPROX. 10-INCH TOTAL (LF) = 221	

NOTES:
1. LINE THROUGH AND DO NOT REINSTATE INTERMEDIATE TWIN MANHOLE UNLESS NECESSARY.

STRUCTURAL CURED-IN-PLACE PIPE								
ASSET ID	MH	TO MH	TYPE	STREET/LOCATION	PIPE DIA (IN)	MATERIAL	APPROXIMATE MH TO MH LENGTH (LF)	REINSTATE ACTIVE SVC. (APPROX. STA)
DL10172	DS06417	DS01636	SURFACE	DELMONT AVENUE	15	RCP	27	-
DL09648	DS01636	DS02603	SURFACE	GRAFTON STREET	10	VCP	91	-
DL09278	DS02603	DS02604	SURFACE	GRAFTON STREET	10	VCP	64	-
DL09279	DS02604	DS02605	SURFACE	GRAFTON STREET	10	VCP	83	0+52
DL09191	DS02606	DS02605	SURFACE	FARRAR AVENUE	10	VCP	259	-
DL07683	DS02605	DS01062	SURFACE	GRAFTON STREET	10	VCP	145	-
DL07745	DS01062	DS00025	SURFACE	GRAFTON STREET	10	VCP	133	-
DL15513	DS00250	DS00025	SURFACE	DANA AVENUE	10	RCP	32	-
DL08924	DS00025	DS01070	SURFACE	GRAFTON STREET	15	VCP	193	1+46, 1+48
DL10287	DS01070	DS01072	SURFACE	GRAFTON STREET	15	VCP	68	-
DL07682	DS01071	DS01072	SURFACE	WARNER AVENUE	10	VCP	29	-
DL09404	DS00026	DS01072	SURFACE	WARNER AVENUE	10	VCP	48	-
DL07404	DS01072	DS01073	SURFACE	GRAFTON STREET	18	VCP	116	0+39
DL09649	DS01073	DS02274	SURFACE	GRAFTON STREET	10	VCP	100	-
							APPROX. TOTAL (LF) = 1,388	APPROX. TOTAL NUMBER OF SERVICES = 4
							APPROX. 10-INCH TOTAL (LF) = 984	
							APPROX. 15-INCH TOTAL (LF) = 288	
							APPROX. 18-INCH TOTAL (LF) = 116	

SEWER MAINLINE CHEMICAL ROOT TREATMENT

ASSET ID	MH	TO MH	TYPE	STREET/LOCATION	PIPE DIA (IN)	MATERIAL	APPROXIMATE MH TO MH LENGTH (LF)
SM13529	SS15126	SS15127	SANITARY	FARRAR AVENUE	8	VCP	261
							APPROX. TOTAL (LF) = 738
							APPROX. 8-INCH TOTAL (LF) = 632

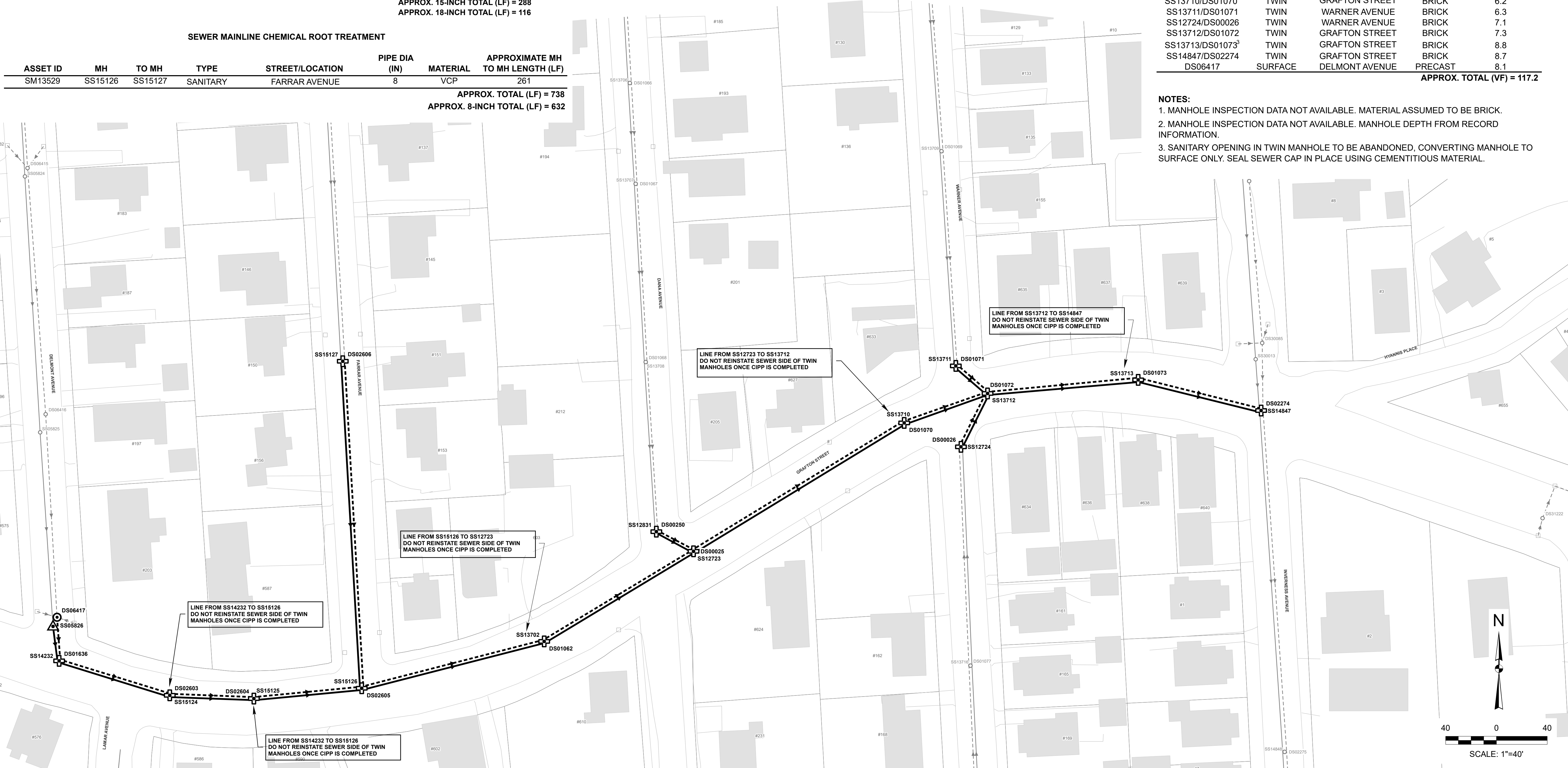

CUT PROTRUDING SERVICE CONNECTION								
ASSET ID	MH	TO MH	TYPE	STREET/LOCATION	PIPE DIA (IN)	MATERIAL	APPROXIMATE MH TO MH LENGTH (LF)	CUT PROTRUDING SVC. (APPROX. STA)
SM11434 ¹	SS13712	SS14847	SANITARY	GRAFTON STREET	10	VCP	221	1+61
							APPROX. TOTAL (EA) = 1	

CURED-IN-PLACE LATERAL LINER											
ASSET ID	MH	TO MH	TYPE	STREET/LOCATION	TYPE	MATERIAL	MAINLINE PIPE DIA (IN.)	LATERAL DIA (IN.)	APPROXIMATE MH TO MH LENGTH (LF)	APPROX. STATION	APPROX. LATERAL LINER LENGTH (LF)
SM12780	SS15126	SS13702	GRAFTON STREET	SANITARY	VCP	VCP	8	6	149	0+62	5
SM12780	SS15126	SS13702	GRAFTON STREET	SANITARY	VCP	VCP	8	6	149	0+88	5
											APPROX. TOTAL (EA) = 2

CEMENTITIOUS MANHOLE LINING AND EXTERIOR SEALING								
MH	TYPE	STREET/LOCATION	MATERIAL	APPROXIMATE MH DEPTH (V.F.)				
SS05826	SANITARY	DELMONT AVENUE	PRECAST	7.8				
SS14232/DS01636	TWIN	GRAFTON STREET	BRICK	6.3				
SS15124/DS02603 ²	TWIN	GRAFTON STREET	BRICK	7.5				
SS15125/DS02604 ³	TWIN	GRAFTON STREET	BRICK	7.5				
SS15127/DS02606	TWIN	FARRAR AVENUE	BRICK	6.6				
SS15126/DS02605	TWIN	GRAFTON STREET	BRICK	6.8				
SS13702/DS01062 ²	TWIN	GRAFTON STREET	BRICK	6.7				
SS12831/DS00250	TWIN	DANA AVENUE	BRICK ¹	9.3 ²				
SS12723/DS00025	TWIN	GRAFTON STREET	BRICK	6.2				
SS13710/DS01070 ²	TWIN	GRAFTON STREET	BRICK	6.2				
SS13711/DS01071	TWIN	WARNER AVENUE	BRICK	6.3				
SS12724/DS00026	TWIN	WARNER AVENUE	BRICK	7.1				
SS13712/DS01072	TWIN	GRAFTON STREET	BRICK	7.3				
SS13712/DS01073 ³	TWIN	GRAFTON STREET	BRICK	8.8				
SS14847/DS02274	TWIN	GRAFTON STREET	BRICK	8.7				
DS06417	SURFACE	DELMONT AVENUE	PRECAST	8.1				
				APPROX. TOTAL (VF) = 117.2				

GENERAL NOTES:
1. CONTRACTOR SHALL VERIFY ALL ACTIVE SERVICE CONNECTION LOCATIONS AND SIZES DURING INITIAL TELEVISION INSPECTION WITH DYE TESTING. SERVICE CONNECTION LOCATIONS AND DIMENSIONS WERE OBTAINED FROM AVAILABLE TELEVISION INSPECTIONS AND MAY NOT BE ACCURATE.
2. SEVERAL MANHOLE DEPTHS WERE OBTAINED FROM AVAILABLE RECORD INFORMATION.

NOTES:
1. MANHOLE INSPECTION DATA NOT AVAILABLE. MATERIAL ASSUMED TO BE BRICK.
2. MANHOLE INSPECTION DATA NOT AVAILABLE. MANHOLE DEPTH FROM RECORD INFORMATION.
3. SANITARY OPENING IN TWIN MANHOLE TO BE ABANDONED, CONVERTING MANHOLE TO SURFACE ONLY. SEAL SEWER CAP IN PLACE USING CEMENTITIOUS MATERIAL.

Project:
CITY OF WORCESTER,
MASSACHUSETTS
DEPARTMENT OF
PUBLIC WORKS

VARIOUS STREETS 2026
SEWER REHABILITATION PROJECT

Weston & Sampson
Weston & Sampson Engineers, Inc.
427 Main Street, Suite 400
Worcester, MA 01608
978.532.1900 800.SAMPSON
www.westonandsampson.com

Consultants:

No.	Date	Description

Revisions:

No.	Date	Description

COA:



Issued For:
RELEASED FOR CONSTRUCTION

Scale: AS NOTED

Date: JUNE 2026
Drawn By: KCW
Reviewed By: KDK
Approved By: FEO
W&S Project No.: ENG25-0036
W&S File No.: SEE PATH

Drawing Title:
PLANS AND TABLES

Sheet Number:
C103

