



June 5, 2026

To All Bidders:

Subject: **Bid #: 8718-W6, Parking Lot Reconstruction – 25 Meade Street / DPF**

ADDENDUM NO. 1

To Whom It May Concern:

With reference to our bid request relative to the above subject, please refer to the changes/modifications/clarifications to the original request.

- **PLEASE SEE ATTACHED & BELOW REVISED DRAWING SHEET INCLUDING UPDATED SCHEDULE AND SCOPE CHANGES**

Added work

1. Demo (4) concrete square fence footings, see plan and photo 14.
2. Demo existing asphalt curb and replace with new at Southern portion of parking lot.

Altered work

1. Provide a full depth removal of existing hatched areas of asphalt paving and any concrete sidewalk subsurface below to existing gravel substrates. Provide 2" gravel fill at areas of remove concrete sidewalk. Assume concrete has steel rebar.
2. Remove cutting of chain link fence. Handwork asphalt paving below.
3. Reduce parking spaces from 9' wide to 8' wide.
4. Pave around existing shed at South elevation, the existing shed to remain in place.
5. One week completion time frame change to contractor having one week work increments noted on drawing.

Bidders are requested to acknowledge and/or include this addendum with submission. All other terms, conditions and specifications remain unchanged.

Very truly yours

Christopher J. Gagliastro - Purchasing Director



PHOTO 1



PHOTO 2



PHOTO 3



PHOTO 4



PHOTO 5



PHOTO 6



PHOTO 7



PHOTO 8

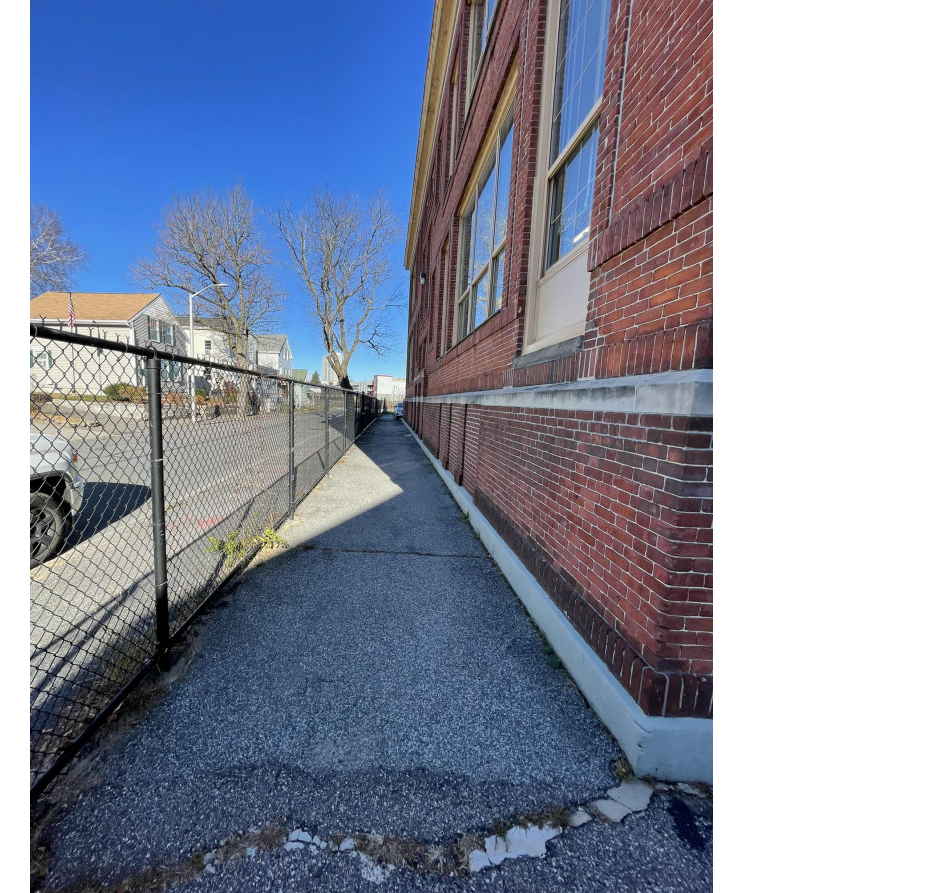

PHOTO 9



PHOTO 10

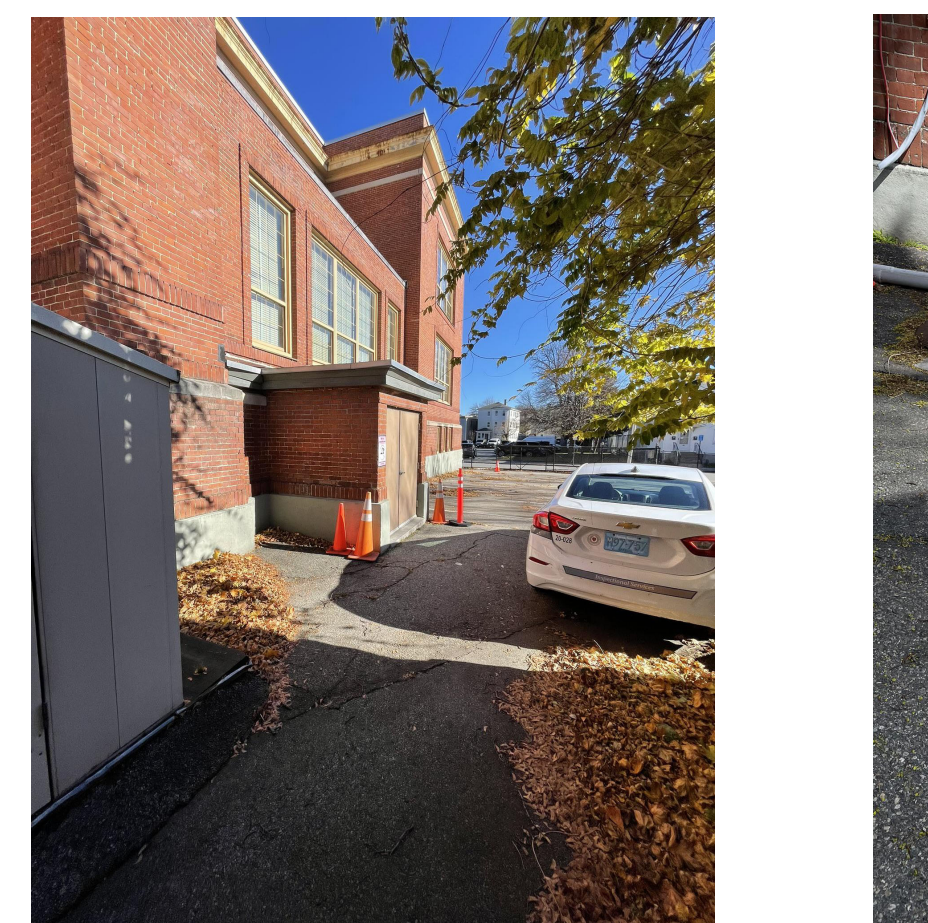

PHOTO 11



PHOTO 12



PHOTO 13



PHOTO 14

SPECIFICATION

SECTION 02745
HOT MIX ASPHALT

PART 1 - GENERAL

1.01 SCOPE OF WORK

- A. Under this Section, the Contractor shall furnish all necessary labor, materials, equipment, and transportation necessary to construct the following:
 1. The bituminous concrete pavement for all roadways shall be composed of materials as specified herein and shall be constructed on a prepared base course to the depth, grade and cross-section shown on the plans, as specified herein and as directed by the Engineer.
 2. Bituminous concrete pavement for roadways shall be composed of a one and one half (1 1/2) inch bituminous concrete binder course, and a one and one half (1 1/2) inch bituminous concrete dense mix course.
 3. Any reference to hot mix asphalt (HMA) on the plans or in the specifications shall relate to this section.

1.02 REFERENCE STANDARDS AND SPECIFICATIONS

- A. Reference to the standards, specifications, and tests of technical societies, organizations and governmental bodies are made in the Contract Documents.
 1. AASHTO - American Association of State Highway and Transportation Officials (tests or specifications)
 2. ASTM - American Society for Testing and Materials
 3. Mass. Standard Specs. - Latest edition of the Standard Specifications for Highways, Bridges and Waterways, 1988 Edition, MASSDOT, hereinafter referred to as "The Massachusetts Standard Specifications."
- B. Penetration for surface treatments shall be washed and free of all dirt and other deleterious materials that impede the adhesion qualities of the system.

PART 2 - MATERIALS

2.01 BITUMINOUS CONCRETE PAVEMENT

- A. Bituminous Concrete Pavement shall consist of binder mix and dense mix courses constructed to the thickness shown on the plans and shall conform to the relevant

04/05/2021 02745-1
BITUMINOUS CONCRETE PAVEMENT
(HOT MIX ASPHALT)

provisions of Sections 460 and (M3.11.03) of the MASSDOT, Standard Specifications for Highways and Bridges, 1988 Edition, unless specified otherwise hereinafter.

PART 3 - EXECUTION

3.01 BITUMINOUS CONCRETE PAVEMENT

- A. The bituminous mixture shall be placed on the approved base only when, in the opinion of the Engineer, the course is sufficiently dry and weather conditions are suitable.
- B. Where walls, curbing, or other suitable permanent supports are not present, the Contractor shall secure proper alignment and adequate compaction of the binder and surface courses as shown on the Contract Drawings and finish all edges with a neat, tapered edge.
- C. The pavement shall be placed in two (2) courses as shown on the Contract Drawings. Each course shall be spread and finished as required in the Massachusetts Department of Public Works, Standard Specifications for Highways and Bridges, Section 460.6, 1988 edition.
- D. After completion, the bituminous concrete courses shall conform to the thickness shown on the Contract Drawings, smooth and even and of a dense and uniform structure. When tested with a sixteen (16) foot straight edge placed parallel to the centerline of the pavement, there shall be no deviation from a true surface more than one-quarter (1/4) inch.

PART 4 - GUARANTEE/WARRANTY

- 4.01 The pavement shall be guaranteed against defects in workmanship or quality for a period of one (1) year after final acceptance.

04/05/2021 02745-2
BITUMINOUS CONCRETE PAVEMENT
(HOT MIX ASPHALT)

FULL DEPTH REMOVAL OF EXISTING PATCH AREAS OF ASPHALT PAVING AND ANY CONCRETE SIDE SURFACE BELOW TO EXISTING GRAVEL SUBSTRATES. RECOMPACT AND PROVIDE NEW ASPHALT PAVING. MAINTAIN EXISTING SLOPES AWAY FROM BUILDING.

APPROXIMATE AREA OF PAVING
18,065 SQ FT (VERIFY)

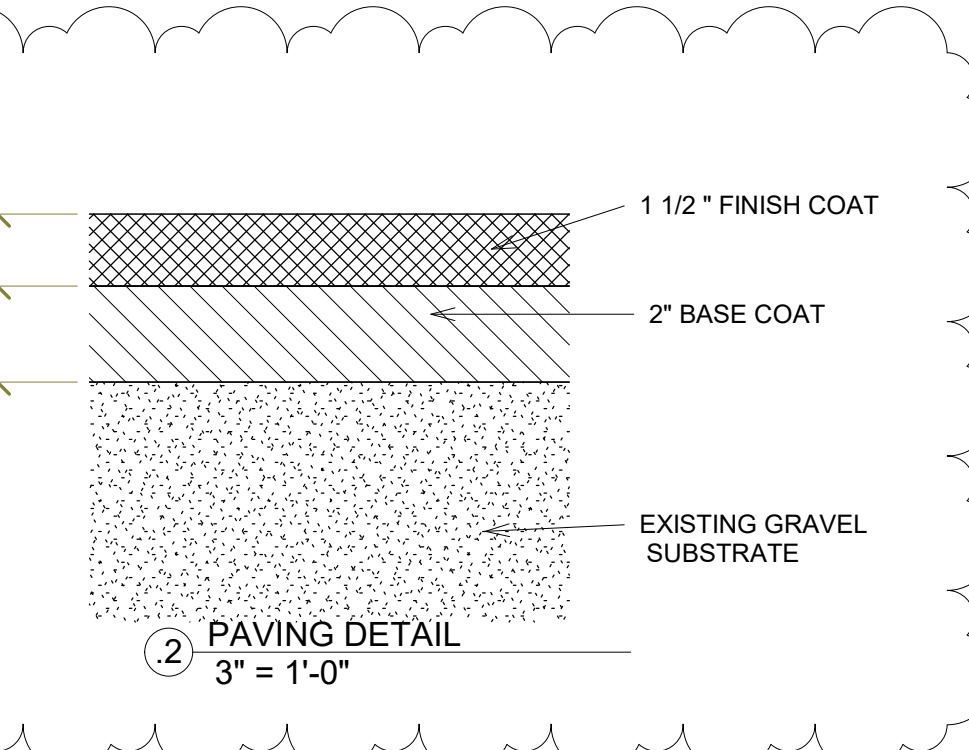

2 PAVING DETAIL
3" = 1'-0"



PHOTO 14
DEMO (4) CONCRETE SQ FENCE FOOTINGS

FENCE SCOPE OF WORK REMOVED (HANDWORK ASPHALT PAVING UNDER AREAS OF FENCE AND ALIGN W/ EXISTING ADJACENT SIDEWALK.

1 PAVING PLAN
1" = 10'-0"

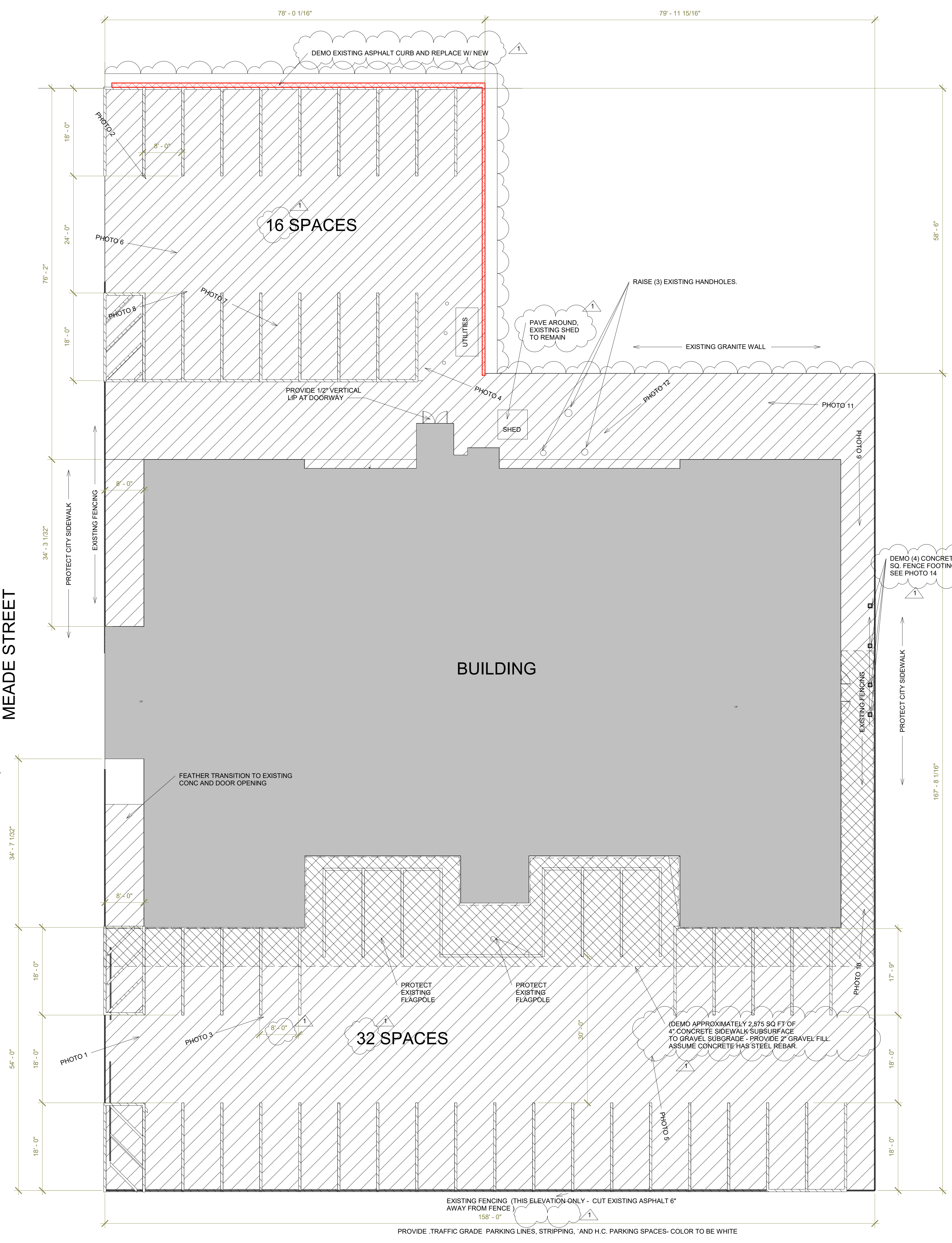

REVISIONS	1 ADDENDUM 1 6/3/26
PLAN NORTH	
KEY PLAN	
ENGINEER	
NOTES:	<p>Work shall be phased within the dates below and usable by the owner for dates in between.</p> <ul style="list-style-type: none"> -July 13th -20th (Contractor Use) -July 21st -26th (Owner Use) -July 27th -Aug 4th (Contractor Use) -Aug 5th -15th (Owner Use) -Aug 17th -24th (Contractor Use)
OWNER	CITY OF WORCESTER
	DEPARTMENT OF PUBLIC FACILITIES
	50 OFFICER MANNY FAMILIA WAY Worcester, MA 01605
PROJECT TITLE	CITY VEHICLE PARKING LOT PAVING 25 Meade Street Worcester, MA 01604
DRAWING NAME	PARKING LOT PAVING PLAN & DETAILS
DATE	REV 06/04/26
SHEET NUMBER	A1.1 SHEET 1 OF 1

CONTRACTOR TO VERIFY EXISTING CONDITIONS AND MEASUREMENTS PRIOR TO BIDDING.
VERIFY UNDERGROUND UTILITIES PRIOR TO WORK