



PHOTO 1



PHOTO 2



PHOTO 3



PHOTO 4



PHOTO 5

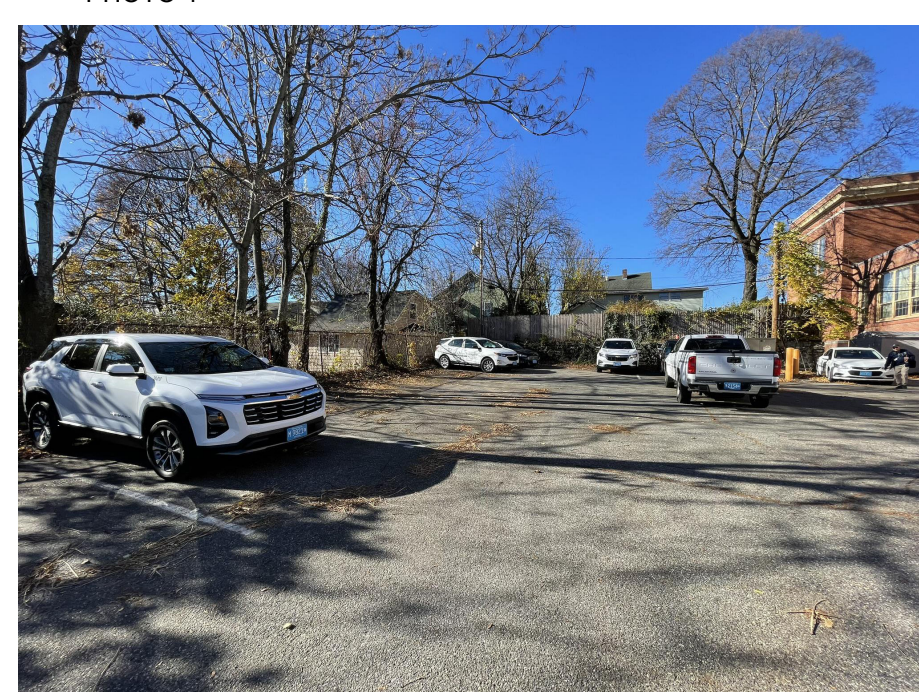

PHOTO 6

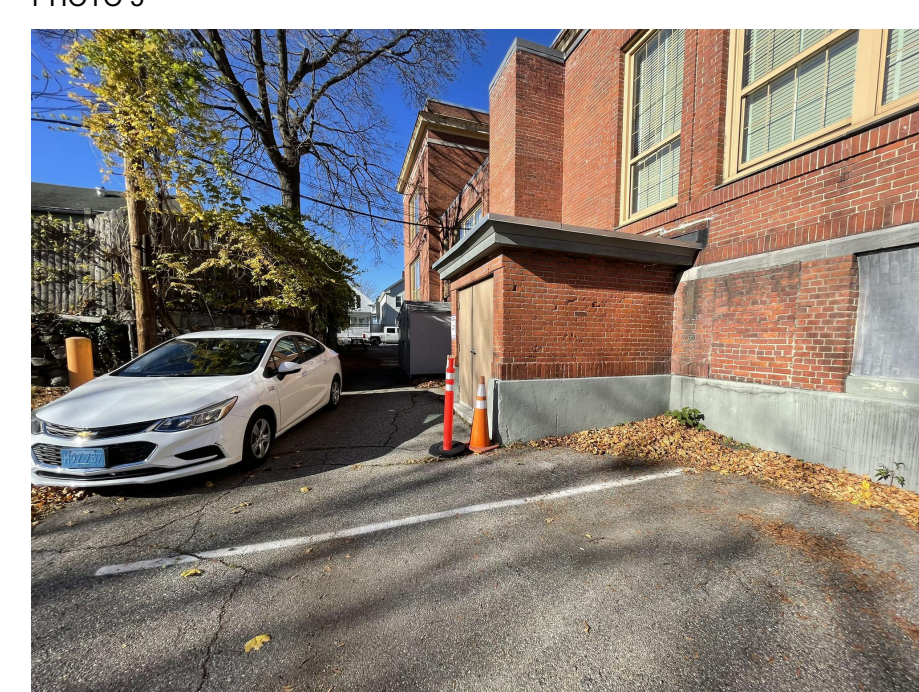

PHOTO 7

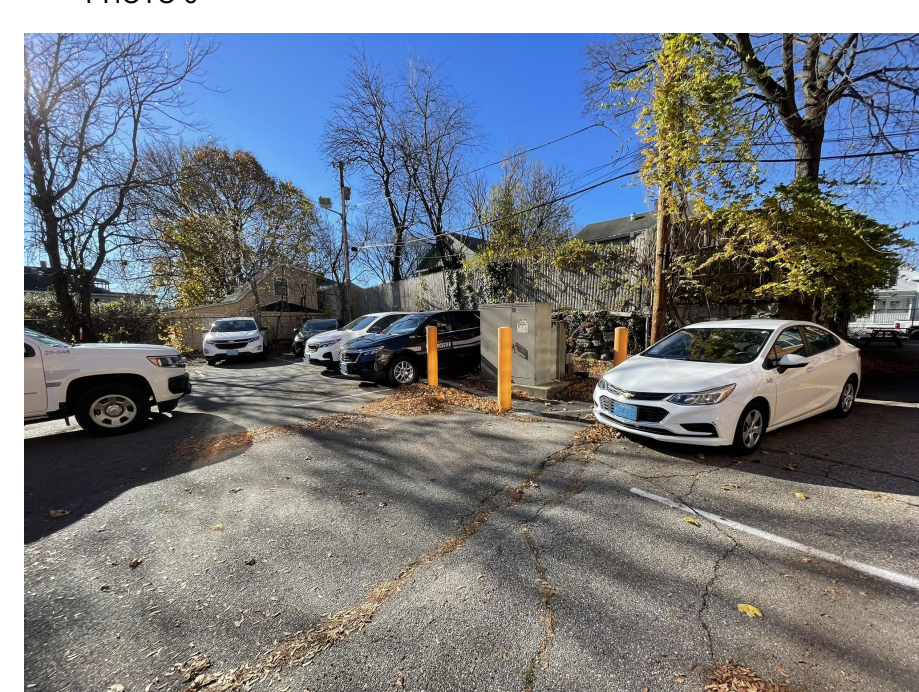

PHOTO 8



PHOTO 9

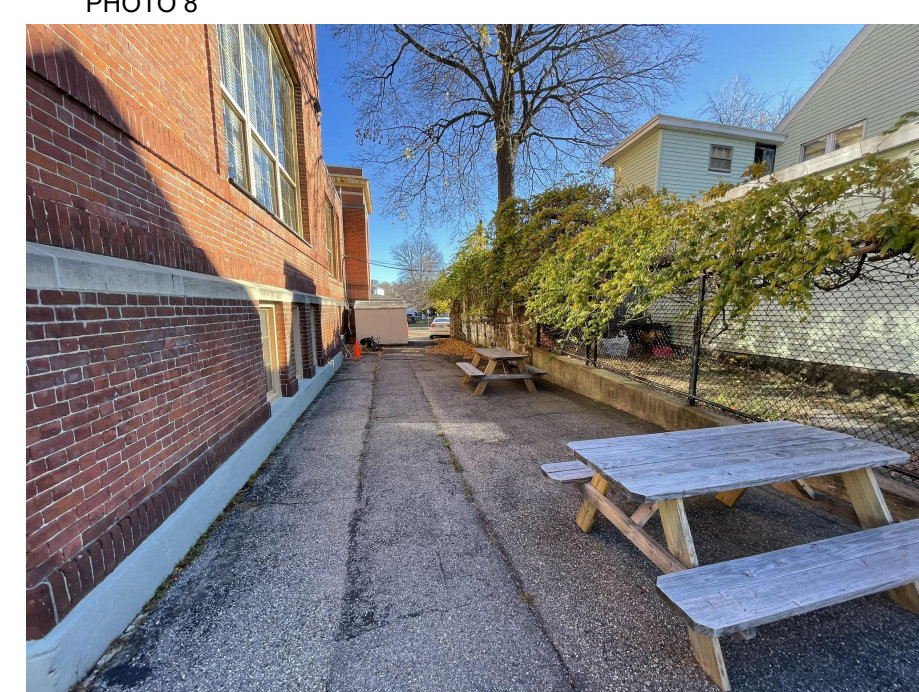

PHOTO 10



PHOTO 11



PHOTO 12



PHOTO 13

SPECIFICATION

SECTION 02745
HOT MIX ASPHALT

PART 1 - GENERAL

1.01 SCOPE OF WORK

- A. Under this Section, the Contractor shall furnish all necessary labor, materials, equipment, and transportation necessary to construct the following:
 1. The bituminous concrete pavement for all roadways shall be composed of materials as specified herein and shall be constructed on a prepared base course to the depth, grade and cross-section shown on the plans, as specified herein and as directed by the Engineer.
 2. Bituminous concrete pavement for roadways shall be composed of a one and one half (1 1/2) inch bituminous concrete binder course, and a one and one half (1 1/2) inch bituminous concrete dense mix course.
 3. Any reference to hot mix asphalt (HMA) on the plans or in the specifications shall relate to this section.

1.02 REFERENCE STANDARDS AND SPECIFICATIONS

- A. Reference to the standards, specifications, and tests of technical societies, organizations and governmental bodies are made in the Contract Documents.
 1. AASHTO - American Association of State Highway and Transportation Officials (tests or specifications)
 2. ASTM - American Society for Testing and Materials.
 3. Mass. Standard Specs. - Latest edition of the Standard Specifications for Highways, Bridges and Waterways, 1988 Edition, MASSDOT, hereinafter referred to as "The Massachusetts Standard Specifications."
- B. Penstone for surface treatments shall be washed and free of all dirt and other deleterious materials that impede the adhesion qualities of the system.

PART 2 - MATERIALS

2.01 BITUMINOUS CONCRETE PAVEMENT

- A. Bituminous Concrete Pavement shall consist of binder mix and dense mix courses constructed to the thickness shown on the plans and shall conform to the relevant

04/05/2021

02745-1
BITUMINOUS CONCRETE PAVEMENT
(HOT MIX ASPHALT)

provisions of Sections 400 and (M3.11.03) of the MASSDOT, Standard Specifications for Highways and Bridges, 1988 Edition, unless specified otherwise hereinafter.

2.03 BITUMIN

- A. Asphalt emulsion or bitumen for application of the stone surface treatment shall conform to the relevant provisions of Sections M3.01.0, M3.03.0, M3.03.1 and M3.02.0 of the MASSDOT, Standard Specifications for Highways and Bridges, 1988 Edition.

PART 3 - EXECUTION

3.01 BITUMINOUS CONCRETE PAVEMENT

- A. The bituminous mixtures shall be placed on the approved base only when, in the opinion of the Engineer, the course is sufficiently dry and weather conditions are suitable.
- B. Where walls, curbing, or other suitable permanent supports are not present, the Contractor shall secure proper alignment and adequate compaction of the binder and surface courses as shown on the Contract Drawings and finish all edges with a neat, tapered edge.
- C. The pavement shall be placed in two (2) courses as shown on the Contract Drawings. Each course shall be spread and finished as required in the Massachusetts Department of Public Works, Standard Specifications for Highways and Bridges, Section 400.0, 1988 edition.
- D. After completion, the bituminous concrete courses shall conform to the thickness shown on the Contract Drawings, smooth and even and of a dense and uniform structure. When tested with a sixteen (16) foot straight edge placed parallel to the centerline of the pavement, there shall be no deviation from a true surface more than one-quarter (1/4) inch.

PART 4 - GUARANTEE WARRANTY

- 4.01 The pavement shall be guaranteed against defects in workmanship or quality for a period of one (1) year after final acceptance.

END OF SECTION

04/05/2021

02745-2
BITUMINOUS CONCRETE PAVEMENT
(HOT MIX ASPHALT)

MILL 1-1/2" DEPTH - EXISTING HATCH AREAS OF ASPHALT PAVING TO EXISTING GRAVEL/CONCRETE SUBSTRATES. RECOMPACT AND PROVIDE NEW ASPHALT PAVING. MAINTAIN EXISTING SLOPES AWAY FROM BUILDING.

APPROXIMATE AREA OF PAVING
18,065 SQ FT (VERIFY)

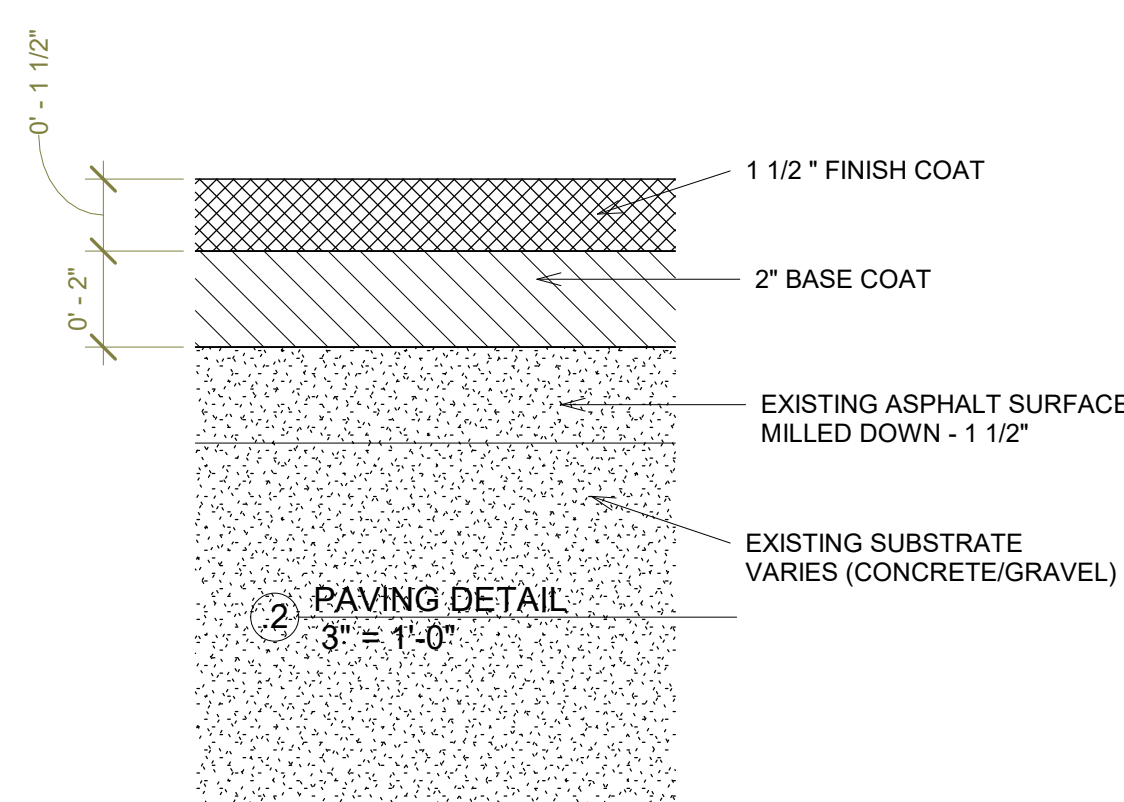

MEADE STREET

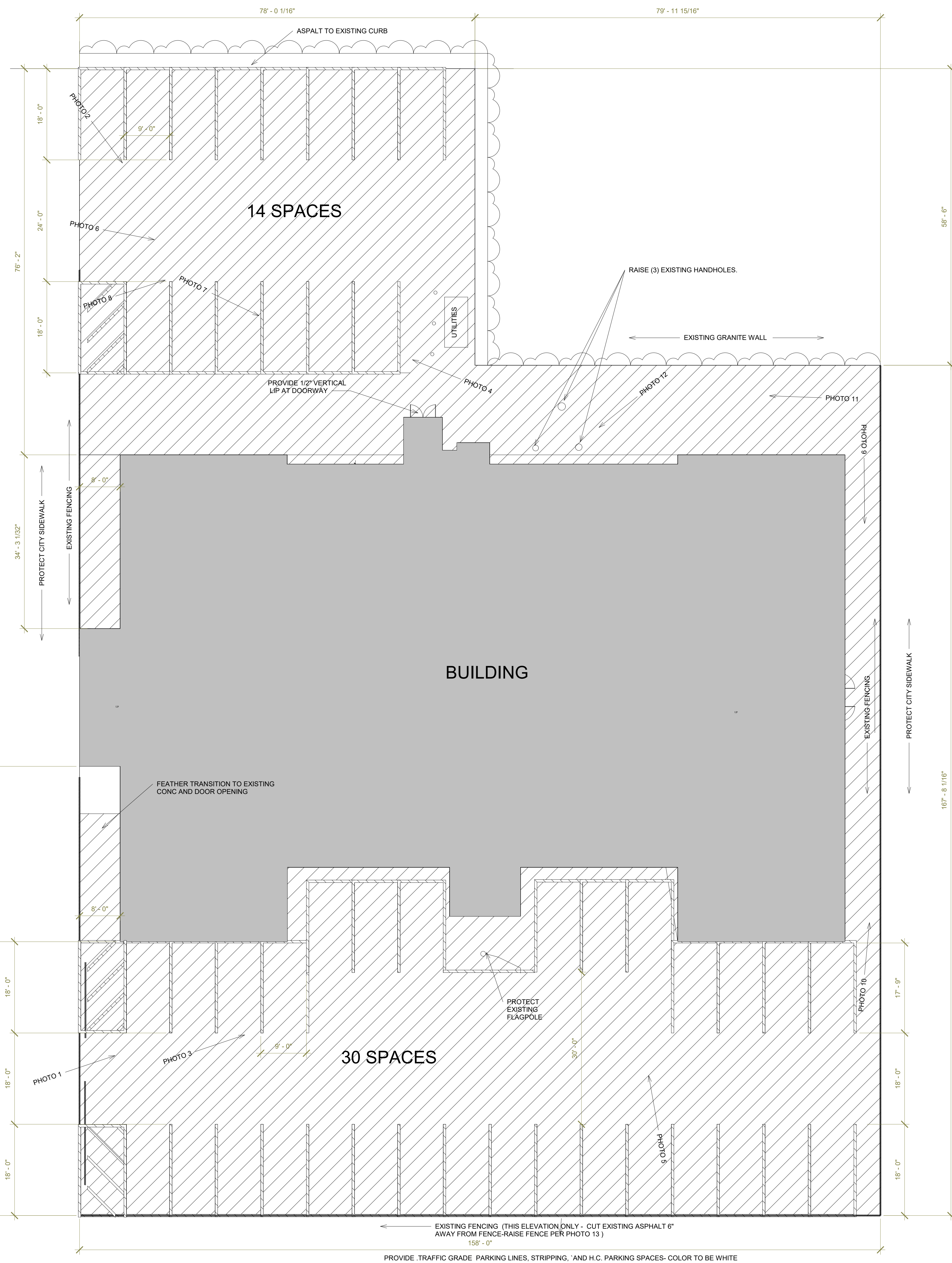

1 PAVING PLAN
1" = 10'-0"

CONTRACTOR TO VERIFY EXISTING CONDITIONS AND MEASUREMENTS PRIOR TO BIDDING.
VERIFY UNDERGROUND UTILITIES PRIOR TO WORK

REVISIONS

PLAN NORTH



KEY PLAN

ENGINEER

NOTES:

On site work shall be continuous and completed within a one week time frame. Paving work dates are to be coordinated with the Woo Sox's away game schedule noted below.
-July 13th -20th
-July 27th -Aug 4th
-Aug 17th -24th

OWNER
CITY OF WORCESTER



DEPARTMENT OF PUBLIC FACILITIES
50 OFFICER MANNY FAMILIA WAY
Worcester, MA 01605

PROJECT TITLE

CITY VEHICLE PARKING LOT PAVING
25 Meade Street
Worcester, MA 01604

DRAWING NAME

PARKING LOT PAVING PLAN & DETAILS

DATE

05/26/26

SHEET NUMBER

A1.1

SHEET 1 OF 1