



The City of **WORCESTER**

Administration & Finance – Purchasing Division
Christopher J. Gagliastro, MCPPO – Purchasing Director
455 Main Street, Room 201, Worcester, MA 01608
P | 508-799-1220
purchasing@worcesterma.gov

May 28, 2024

To All Bidders:

Subject: **Bid No. 8193-M4 Sewer Line Repairs (CIPP) / WPS**

ADDENDUM NO. 2

To Whom It May Concern:

With reference to our bid request relative to the above subject, please refer to the changes/modifications/clarifications to the original proposal request.

Questions received by our office and answers from the City:

- What is the size (diameter) of each cleanout and is each cleanout fully accessible from the surface level? **At Burncoat Elementary, the cleanout is accessible from the at-grade parking lot and also the interior access pit. At Durkin Admin Bldg., the lateral access is via two interior pits inside the basement level of the building.**
- Does each lateral terminate at a connection to a sewer main or does each lateral discharge and end directly in an existing sewer manhole? **At Burncoat Elementary, the lateral terminates directly into a sanitary main on Hastings St, not a manhole; the DPW field verified this on 5/24/2024. At Durkin Admin Bldg., the access is via two interior pits inside the basement level of the building. The Northern sanitary line at this location terminates into a manhole, while the southern line connects directly into the sanitary main.**
- If each lateral terminates at the connection to a City sewer main, can you provide plans showing main line sewer sizes, MH locations and verify the Contractor has permission to access the lateral via the sewer mains? **At Burncoat Elementary, the connected main is an 8" sanitary line on Hastings St. At Durkin Admin Bldg., the connected main is an 8" sanitary line on Irving St. Given the WPS is a Department of the City of Worcester, permission to access the mains on the public ROW will be granted to the awarded vendor.**
- If the laterals terminate at a connection to a sewer main, does the Owner want the connection of the lateral to the main to be sealed using a "t-liner" or equivalent type process in addition to the CIPP lining of the lateral? **A "T-liner" should be provided at any connection that does not terminate in a manhole.**
- **At all three pit locations (one at Burncoat, two at Durkin Admin Bldg), the awarded vendor shall remove the existing "house/building traps" and replace them with code compatible cleanouts.**



The City of WORCESTER

Administration & Finance – Purchasing Division
Christopher J. Gagliastro, MCPPO – Purchasing Director
455 Main Street, Room 201, Worcester, MA 01608
P | 508-799-1220
purchasing@worcesterma.gov

Burncoat Elementary:

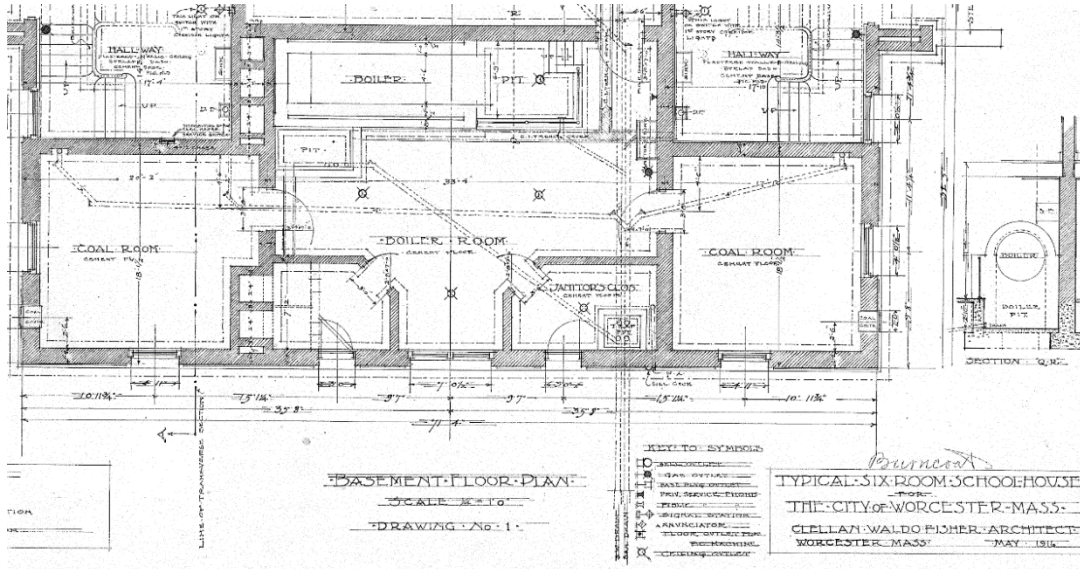



The City of **WORCESTER**

Administration & Finance – Purchasing Division
Christopher J. Gagliastro, MCPPO – Purchasing Director
455 Main Street, Room 201, Worcester, MA 01608
P | 508-799-1220
purchasing@worcesterma.gov

Burncoat Elementary Exterior Plan:

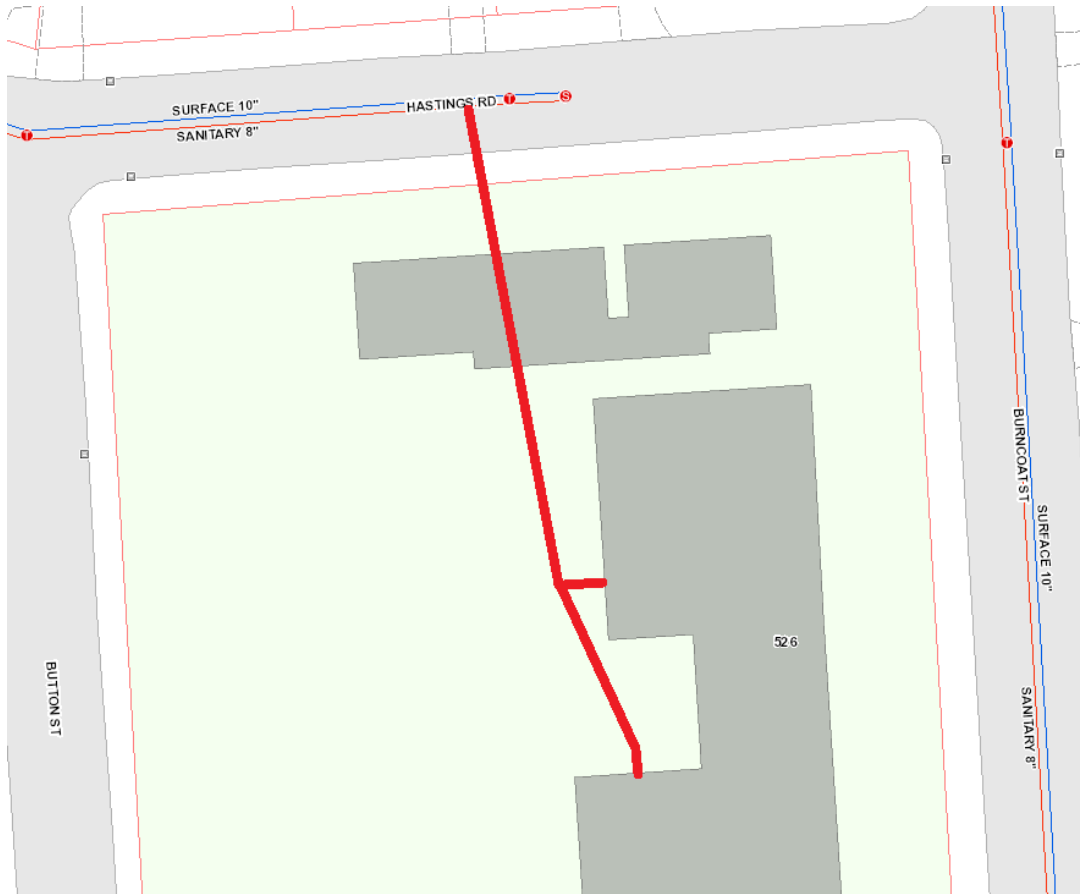



The City of **WORCESTER**

Administration & Finance – Purchasing Division
Christopher J. Gagliastro, MCPPO – Purchasing Director
455 Main Street, Room 201, Worcester, MA 01608
P | 508-799-1220
purchasing@worcesterma.gov

Durkin Admin Bldg:

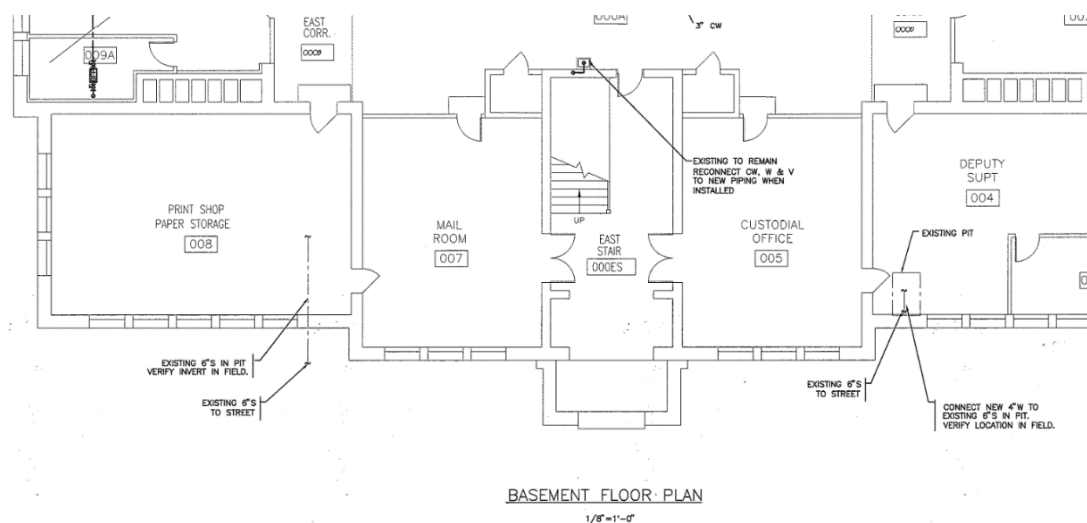

Please also see .pdf attachments “Classical High Irving Street” and “526 Burncoat Street”

Bidders are requested to acknowledge and/or include this addendum with submission. All other terms, conditions and specifications remain unchanged.

Very truly yours,

Stephen R. McDonald
Assistant Purchasing Director