

**DEPARTMENT OF PUBLIC WORKS & PARKS**

**WATER OPERATIONS**

**WORCESTER, MASSACHUSETTS**

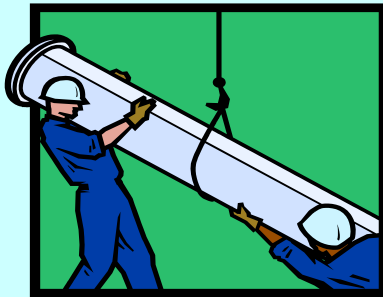

**BID AND SPECIFICATIONS**

**FOR**

**WATER MAIN REPLACEMENT  
(186-23)**

**\*\*\***

**JUNE 2023**

**BID #:8028-M3**

**WATER MAIN REPLACEMENT 186-23**  
**BID #:8028-M3**

**TABLE OF CONTENTS**

<b><u>Description</u></b>	<b><u>Page</u></b>
Title Sheet . . . . .	1
Table of Contents . . . . .	2
Information for Bidders (General) . . . . .	3 to 4
General Specifications . . . . .	5 to 11
Special Provisions . . . . .	12 to 14
Liquidated Damages . . . . .	15
References . . . . .	16
Proposal Items . . . . .	Proposal sheet 1 to 6
Total Bid Proposal . . . . .	Proposal sheet 7

## **WATER MAIN REPLACEMENT 186-23**

**BID #: 8028-M3**

### **INFORMATION FOR BIDDERS**

**This bid consists of the installation of above ground temporary water pipes; the removal of existing old, unlined cast iron water mains; the installation of approximately 6,700 feet of new 6", 8" and 12" polyethylene wrapped, zinc coated ductile iron water main with all associated water service and hydrant connections on various streets throughout the City as listed below.**

#### **STREET**

**Brandon Road  
Calumet Avenue  
Drury Lane  
Eagle Road  
Eagle Terrace  
Pasadena Parkway  
Quinapoxet Lane**

#### **LIMITS**

**Quinapoxet Lane to Clark Street  
Ontario Street to Squantum Street  
Massachusetts Ave to Sheffield Road  
Waycross Street to end  
Eagle Road to end  
Lincoln Street to Wayside Road  
Burncoat Street to St. Nichols Ave**

**NOTE:** In addition to the work listed above, water mains and proportional quantities of associated items may also be required at additional residential streets to be named later. All work to be done under these to be named streets shall be done at contract bid unit prices and funded through the contingency should that funding remain available.

**NOTE: CITY OF WORCESTER DEPARTMENT OF PUBLIC WORKS STANDARD SPECIFICATIONS & DETAILS VERSION 02-15-2022 including subsequent addendum shall APPLY to all listed work.** Specifications (not included in printed version of this document) are available online at the purchasing web site under this bid listing at; <http://www.worcesterma.gov/e-services/bids/open-bids>. They are also located at the DPW&P web location at <http://www.worcesterma.gov/dpw/engineering>

Or they are also available directly at Worcester DPW&P, 20 East Worcester St., Worcester MA.; Monday through Friday 7:30 AM through 4:00 PM.

There will be a pre-bid meeting, at the date and time specified at the beginning of the total bid package. Attendance at this meeting is strongly encouraged.

## **WATER MAIN REPLACEMENT 186-23**

### **BID #: 8028-M3**

The specific limits of the work for the named streets are designated on the drawings, which are part of the contract documents. Bidders should inspect the site of the work and satisfy themselves as to actual conditions and requirements of the work and the accuracy of the estimated quantities.

The bidder should thoroughly acquaint himself with the Agreement Forms used by the City's Law and Purchasing Departments so that they will know what their obligations are before they submit their proposal. These forms can be reviewed at the City of Worcester, Purchasing Department, City Hall, Room 201, 455 Main Street, Worcester, MA.

A certified check or bid bond made payable to the "City Treasurer, City of Worcester" in the amount of 5% of total bid shall accompany this bid.

The bid deposit will be returned within seven (7) days after the opening of the proposals with the exception of the three (3) lowest responsible and eligible bidders.

The Contractor shall be required to perform the work in sequence as directed by the Project Engineer. The Contractor **will be expected to start work as soon as the contract is signed and shall be completed by November 15, 2024.**

The City of Worcester may award or may have awarded other contracts for work on or adjacent to the site and the Contractor shall cooperate fully with such other Contractors by scheduling his own work with that to be performed under other Contracts as may be directed by the Commissioner. The Contractor shall not commit nor permit any act, which will interfere with the performance of work by any other Contractor as scheduled.

**BID #: 8028-M3** shall include all specifications and plans as included in the documents. More detailed plans of some drawings may be found on the City's Purchasing web site, <http://www.worcesterma.gov/e-services/bids/open-bids>.

Award of **BID #: 8028-M3** shall be based upon the Total Contract Bid Price from Page 7 of the Proposal section of the bid documents.

# **WATER MAIN REPLACEMENT 186-23**

**BID #: 8028-M3**

## **GENERAL SPECIFICATIONS**

### **1.01 DEFINITION OF TERMS**

Wherever the following words or phrases are used in these specifications, their intent and meaning shall be as follows:

1. City = the City of Worcester, MA.
2. Commissioner = the Commissioner of Public Works and Parks of the City of Worcester.
3. Assistant Commissioner = the Assistant Commissioner of Public Works and Parks of the City of Worcester.
4. Director = the Director of Water and Sewer Operations, Department of Public Works, and Parks of the City of Worcester.
5. Field Engineer = the field representative of Water Operations, Department of Public Works, and Parks of the City of Worcester.
6. Contractor = the person or persons, co-partnership or corporation who have entered into this contract as parties of the second part, or them or their legal representative.

### **1.02 EXISTING UNDERGROUND FACILITIES**

1. Before making any excavation in a street, the Contractor shall notify all public utilities that they are making an entry, in accordance with Chapter 370, Acts of 1963 Massachusetts Law.
2. The Contractor shall ascertain the location of existing underground facilities and so conduct their work that those facilities shall not be damaged. The Contractor shall be fully responsible for damage to existing facilities and shall pay all costs of repairing damage caused by them or their agents.
3. Sewer connections or drains which are broken by the Contractor shall be repaired by a licensed drain layer, under the inspection of the DPW&P Permits division and paid for by the Contractor.
4. The City of Worcester, Department of Public Works, and Parks, is not a participating member of the "Dig Safe" network. To get water lines, street wires and conduits and sewer mains marked out, the Contractor shall contact **DPW&P Customer Service (508) 929-1300** at least 72 hours in advance of any execution.

# **WATER MAIN REPLACEMENT 186-23**

**BID # : 8028-M3**

## **1.03 INVESTIGATION OF CONDITIONS**

Contractors are expected to visit the locality of the work and acquaint themselves with all available information concerning local conditions. They are also expected to make their own estimates of the facilities needed and difficulties attending the execution of the proposed contract including the local conditions, availability of labor, uncertainties of weather and other contingencies.

In no event will the City assume any responsibility whatsoever for any interpretation, deduction or conclusion drawn from the inspection of the site. Failure to acquaint himself with all available information concerning these conditions will not relieve the Contractor from responsibility for estimating the difficulties and cost of successfully performing the complete work.

## **1.04 GENERAL SCOPE OF THE WORK TO BE PERFORMED**

The work to be done under these Specifications will consist of the performing of such services and furnishing of such materials, except such material as is agreed to be furnished by the City at the location stated and as listed in the Proposal, and of doing all the miscellaneous work connected therewith. It shall include making excavations and backfilling, protection of the work, temporary street surface patching, furnishing, and installing the necessary temporary by-pass pipes, installing water mains and appurtenances, cleaning up the work site, chlorinating and flushing the water mains, and testing of completed work for leaks.

## **1.05 DRAWINGS**

1. The work shall be done in conformity with the plans and specifications and such modifications thereof as may be determined by the Assistant Commissioner, and with all conditions and requirements of these specifications and under the direction and supervision of the Assistant Commissioner.
2. The length, size and location of the mains and other necessary information will be shown on a plan for each street in which mains are to be laid or as specified herein.
3. The plans are to be considered diagrammatical only. The final location is subject to such changes as may be necessary to avoid surface structures, underground pipes, sewers, conduits, etc. The location may be anywhere within the street limits and will be determined as work proceeds.

## **WATER MAIN REPLACEMENT 186-23**

**BID #: 8028-M3**

### **1.06 CITY ORDINANCES**

The Contractor shall comply with all City ordinances regarding public work, the use of streets and highways, and the safety of the public, and with the regulations of the Department of Public Works of the Commonwealth of Massachusetts, when working in streets under their control.

### **1.07 RISKS FOR DELAY**

The Contractor shall assume the risk of any and all delays arising from the nature of the work or from any unforeseen casualties, obstructions, or difficulties which may arise or be encountered in the doing of the work, or from the action of the elements, or other Contractors, or persons or otherwise; and further agrees that no claim for damages or extra compensation will be made by reason of any delay whatsoever.

### **1.08 INSPECTION**

It is agreed that the Commissioner may appoint and employ at their own expense such officers as may be necessary, who are to act as engineers, inspectors, or agents for the purpose of supervising in the City's interest the materials furnished and the work done, as same progresses. Such officers shall have unrestricted access to all parts of the work and other places at and in which the preparation of materials and the construction of the different parts of the work to be done under these specifications are carried on and conducted and shall be given by said Contractor all facilities and assistance required to carry out their work of inspection and testing in a manner satisfactory to the Commissioner and Assistant Commissioner.

**All work shall be completed in the presence of the Field Engineer.**

### **1.09 RIGHT OF REJECTION**

Such officers shall have authority to reject any work, materials, and parts thereof, which do not in their opinion, conform to the Plans, Drawings and Specifications; it shall be admissible for them to do so at any time during the progress of the work, and until its completion and acceptance, notwithstanding the fact that any such defective work or materials may have been previously overlooked and received.

### **1.10 REJECTED MATERIAL AND DEFECTIVE WORK**

The Contractor at their own expense shall promptly replace all defective work. At the request of the Commissioner or their representative, the Contractor shall remove any portion of the work done, as they may at some time think necessary

**WATER MAIN REPLACEMENT 186-23**  
**BID #: 8028-M3**

for the discovery of improper materials or workmanship, and the Contractor shall restore such work, at their own expense in case it is found defective.

**1.11 UNLOADING**

The said Contractor agrees that they will, at their own expense, furnish all the means, appurtenances, and conveniences necessary for the delivery to the site of all material entering into the construction of the work including the delivery of pipes, valves, valve boxes, and other castings as defined in the specifications; and they agree that said City shall not be held responsible for the care and protection of said material and parts thereof, however, or wherever delivered, until the final acceptance of the work.

**1.12 PERMITS TO OPEN STREETS AND INSTALL WATER MAINS AND SERVICES**

1. Before any trench is opened in a public or private street and before any water main or water service is installed, replaced, or repaired, in the City of Worcester, a permit shall be obtained from Department of Public Works and Parks, Permit office at 20 East Worcester Street.
2. Before any trench is opened in a State Highway, a permit shall be obtained from the District Highway Engineer. This permit shall be taken out by DPW&P Water Operations.
3. A water and a trench permit shall be drawn regardless of whether the work is being done on public or private property. The Contractor obtaining the permit shall be City of Worcester licensed and bonded drain layer only.

**1.13 TRAFFIC TO BE MAINTAINED**

Travel over streets where pipes are being laid shall be interrupted or obstructed as little as possible. The Commissioner may, at their discretion, direct that certain portions of the streets shall be clear of all excavated material, that at certain street intersections only a portion of the trench shall be excavated at a time and closed again before the pavement over the balance is removed; and that no two adjoining street intersections be excavated at the same time. The Contractor shall erect temporary bridges and crossings at no additional compensation as determined by the Field Engineer.

**1.14 PROTECTION OF TREES AND SHRUBS**

The Contractor shall exercise every precaution to protect from injury all trees and shrubs not directly in the line of the water main or water service, and upon completion of the work shall restore the ground to its original condition without



**WATER MAIN REPLACEMENT 186-23**  
**BID #: 8028-M3**

additional compensation.

**1.15 BLASTING**

Blasting, where necessary, shall be done with proper precautions to prevent injury or damage to persons and property. The Bond required by law and necessary permit from the Fire Chief shall be secured and filed.

**1.16 PIPE LAYING IN PRIVATE STREETS OR RIGHT-OF-WAYS**

1. When pipe is laid in a private street, or through private property, the surface of the ground shall, after the laying of the pipe, be carefully and promptly restored to the condition it was in previous to the laying of pipe.
2. When pipe is laid in a street that is being improved, as little interference as possible shall be caused to the street improvement work, and this contractor shall cooperate fully with the street contractor.

**1.17 RECONSTRUCTION OF SUB-SURFACE STRUCTURES**

1. In case it shall, in the opinion of the Commissioner, become necessary to divert or reconstruct any culvert, sewer, manhole valve chamber, catch basin connection, water main, house connection to water mains or sewers, in a new location, said work shall be done by the Contractor upon order from the said Commissioner.
2. Provisions must be made by the Contractor to take care of the drainage without damage to the work until the culvert, sewer, catch basin connection, and drains shall have been reconstructed and restored to service.
3. In case it shall, in the opinion of the Commissioner, become necessary to divert or reconstruct water mains or water service branches, said work shall be done by the Contractor.
4. In case it shall, in the opinion of the Commissioner, become necessary to divert and/or reconstruct any gas main or electric conduit or any connections thereto, the company owning same shall be notified to divert same by the Commissioner or their agent. In no case shall the Contractor make any change in the position of any gas pipe, electric conduits, or fixtures, without the written consent of the proper parties or an order from the Commissioner.

**1.18 FENCES, DANGER SIGNALS, ETC.**

## **WATER MAIN REPLACEMENT 186-23**

### **BID #: 8028-M3**

The Contractor, at their own expense, shall erect and maintain all necessary fences, barricades, and danger signals. The lights shall be kept on from sunset until sunrise, and necessary watchmen shall be provided for the safety of the public. The Contractor shall observe such rules relative to signals and safeguards, as the police regulations, laws and ordinances require.

#### **1.19 CLOSING OF VALVES**

DPW&P Water Operations employees, assisted by the Contractor, shall do the closing and opening of valves necessary for making connections with existing mains. Sufficient notice shall be given the Director of the time for shutting off. No allowance will be made for any delay in closing of valves. A 24-HOUR NOTICE must be given to residents or businesses affected by the shut-down and will be done by the Contractor under the direction of the Field Engineer.

#### **1.20 CLEANING OF STREETS**

Immediately upon completion of the work, refuse material and other material shall be removed by the Contractor at their own expense from the streets occupied by them during construction, and the streets shall be cleaned and restored to their original condition.

#### **1.21 TRESPASS**

The Contractor shall not allow anyone in their employ to damage the property of the City, or trespass on premises in the vicinity of the work. At the request of the Assistant Commissioner, they shall discharge from their employ any person guilty of such offenses, and they shall be held responsible for any acts of their employees. All buildings, fences, sidewalks, trees, and other properties shall be protected from injury, and the Contractor shall be held responsible for any damages done to the same in any way, or by his act of neglect, or that of their agents, or by their act of neglect, or that of their agents, employees, or workmen.

#### **1.22 DAMAGES TO PROPERTY**

Special care must be taken by the Contractor not to allow any material of any kind to be deposited on any sidewalk, curb or sodding, and any damages caused by violating this provision must be made good by the Contractor at their own cost, and to the satisfaction of the Field Engineer.

#### **1.23 RESPONSIBILITIES**

The Contractor shall be responsible for their work for five (5) years starting on the day the work has been accepted by the City.

## **WATER MAIN REPLACEMENT 186-23**

### **BID #: 8028-M3**

#### **1.24 BORROWING OF MATERIALS**

In the event the Contractor encounters a material delivery problem and, therefore, desires to borrow City-owned materials, they shall first seek permission to do same from the Director. If the quantity of City-owned materials on hand is such that a loan may be made, the Director may grant approval and the Contractor shall present the original copy of their purchase order showing the vendor's name who can properly replace said borrowed materials to the City storekeeper in charge of the store yard. Said purchase order shall contain the correct quantity and specifications to replace with identical materials to the original point of pick-up and in addition, said purchase order will also bear the signature of an authorized representative of the Contractor.

#### **1.25 PROPER NOTICE BEFORE STARTING WORK**

The Contractor shall be responsible for a minimum of one-week notice to Water Operations before starting work on a given street.

#### **1.26 INEFFICIENCY OF INSPECTOR NOT TO PRECLUDE**

The Contractor agrees that any omission, inefficiency, negligence, or incapacity on the part of any or all such officers in exacting the full requirements of the Plans, Drawings and Specifications, shall not release the Contractor from supplying the same whenever it may be found that failure to meet requirements have occurred up to the final completion and acceptance of the work.

#### **1.28 SEPARATION OF WATER MAINS AND SEWERS**

All sanitary lines shall be laid at least 10 feet horizontally from any existing or proposed water line. The distance shall be measured edge to edge.

In areas where it is necessary to install sanitary lines with less than 10 feet horizontal distance from a water line the sanitary line shall be enclosed in concrete.

All sanitary lines crossing water lines shall be laid to provide a minimum vertical distance of 18 inches between the outside of the water main and the outside of the sewer. The sanitary line shall always cross under the water line unless directed by the Field Engineer. When an 18-inch vertical distance is not achievable the sanitary line shall be enclosed in concrete.

## **WATER MAIN REPLACEMENT 186-23**

**BID #: 8028-M3**

### **SPECIAL PROVISIONS**

The following conditions and restrictions shall apply to all work performed under this contract:

1. The Contractor shall be required to have on-site at all times during the course of construction activities, a full-time superintendent who shall be in responsible charge of the project. This shall be the exclusive agent for the Contractor maintaining continuous correspondence with the Field Engineer.
2. The Contractor shall notify the City in writing whenever there is a change of superintendents.
3. The Contractor shall submit to Water Operations Engineering a schedule of operations within ten (10) days after the mailing of the executed contract to the Contractor. The schedule shall detail the proposed methods of construction, the sequence of work and the time the Contractor proposes to complete the various items of work within the time specified in the contract.
4. The Contract Compliance Office requires certified payrolls be submitted on a weekly basis from the first week of work through the final week of work, regardless of whether they were on site or not. If they did not work during a particular week, they **must** submit a payroll stating that. It shall not be necessary for the Contractor to submit payrolls to any other agency. These submissions shall be a prerequisite to the City making any periodic or final payments to the Contractor. Failure to submit the required certified payroll shall result in the withholding of payments or final retainage release.
5. The Contractor shall, prior to beginning work on each street or phase of the contract, submit to Water Operations Engineering, a digital record the street and sidewalk conditions of the street to be excavated. This record shall consist of video and/or photographic images of the street and street conditions prior to the start of any construction. Special note shall be made of any difficult or problem areas that could present problems for either the Contractor or property owners adjacent to the construction site. Similar post-construction records shall also be submitted after final restoration has been completed. All video and/or photos shall be supplied to the City at no additional expense to the City.
6. A 24-hour emergency telephone number shall be supplied along with the name of the person to be notified for all repairs and emergencies that may occur. Failure to respond shall necessitate the actuation of City crews at the Contractor's expense.

## **WATER MAIN REPLACEMENT 186-23**

### **BID #: 8028-M3**

7. Police Officers for traffic control shall be furnished at the discretion of the Contracting Officer at the City's expense.
8. In accordance with section 1, item 1.12, the Contractor shall be required to obtain a permit to open a public or private street at no additional cost to the Contractor. Failure to obtain the required street opening permits shall result in the withholding of payments or final retainage release. These permits are available at the DPW&P Permit office at 20 East Worcester St.
9. Controlled Density Fill may be required as the backfill material at selected openings in any of the streets included in this bid. Field conditions shall dictate placement and shall be at the discretion of the Field Engineer.
10. The CITY shall employ the services of a certified testing contractor to ensure proper compaction of all trenches. Special note shall be made to Section 3, paragraph D, **EXCAVATION, TRENCING AND BACKFILLING**, of City of Worcester Standard Specifications & Details for related information of compaction requirements.
11. The City, at its discretion, may choose to perform the permanent paving on certain streets with City forces or a different contractor under the DPW's "Cooperative Paving Program". Should a street be done under this cooperative program, the contractor shall be relieved of the responsibility of performing the permanent paving on that street, and the dollar value of the work will be removed from this contract in order to fund the Cooperative Paving Program. No guarantees are made that any streets will or will not be included under this program.
12. **The CITY requires the use of approved ramps for all driveway crossings of temporary by-pass lines. No temporary pavement, gravel or other material will be allowed unless approved by DPW&P in advance.**

#### **Item 301.50 Ductile Iron Pipe and Polyethylene Wrap with Sand Envelope**

All ductile iron pipe installed as part of this contract shall be encased in an approved polyethylene wrap. This pipe and wrap shall be bedded in a sand envelope per the revised City of Worcester standard specifications. This sand envelope shall be the width of the trench from 6" below the pipe to 12" above the pipe. The remainder of the trench shall be backfilled per the City Specifications.

#### **Item 301.01 1" Polyethylene Pipe for Change of Services**

All water services  $\frac{3}{4}$ " or 1" in size shall be relayed or replaced with new 1" polyethylene tubing from the new 1" corporation stop at the new DI water main to the property line. All new service pipes shall be trenched over their entire

**WATER MAIN REPLACEMENT 186-23**

**BID #: 8028-M3**

length. No pulling or driving of services shall be allowed. These new service pipes shall be encased in a sand envelope per the revised City of Worcester standard specifications.

**WATER MAIN REPLACEMENT 186-23**

**BID #: 8028-M3**

**LIQUIDATED DAMAGES  
(CONTRACTS OF \$100,000.00 OR MORE)**

It is expressly understood and agreed, by and between the Contractor and the City, that the time for completion of the work described herein is a reasonable time for the completion of the same, taking into consideration the average climatic range and usual industrial and / or residential conditions prevailing in the locality. If the said Contractor shall neglect, fail or refuse to complete the work within the time herein specified, or any proper extension thereof requested in writing by the Contractor and granted in writing by the Contracting Officer, then the Contractor does hereby agree, as a part consideration for the awarding of this contract, to pay the City the amount of \$150.00 per day, not as a penalty but as liquidated damages for such breach of contract, for each and every calendar day that the contractor shall be in default after the time stipulated for completing the work. The said amount of \$150.00 per day is fixed and agreed upon by and between the Contractor and the City because of the impracticability and extreme difficulty of fixing and ascertaining the actual damages the City would in such event sustain, and the said amount shall be deducted by the City from periodic payments.

It is understood that the winter months of December, January, February, and March shall be excluded from the Liquidated Damages and the Contractor shall not suffer any penalty for not working during that period.

**WATER MAIN REPLACEMENT 186-23**  
**BID #: 8028-M3**

**REFERENCES**

The bidder is requested to state below what work of a similar character to that included in the Proposal Contract he/she has done and give references that will enable the City to make inquiries and to judge of his/her experience, skill, available financial resources, credit, and insurance standing.

1. \_\_\_\_\_  
\_\_\_\_\_  
\_\_\_\_\_  
\_\_\_\_\_
2. \_\_\_\_\_  
\_\_\_\_\_  
\_\_\_\_\_  
\_\_\_\_\_
3. \_\_\_\_\_  
\_\_\_\_\_  
\_\_\_\_\_  
\_\_\_\_\_
4. \_\_\_\_\_  
\_\_\_\_\_  
\_\_\_\_\_  
\_\_\_\_\_
5. \_\_\_\_\_  
\_\_\_\_\_  
\_\_\_\_\_  
\_\_\_\_\_
6. \_\_\_\_\_  
\_\_\_\_\_  
\_\_\_\_\_  
\_\_\_\_\_



# WATER MAIN REPLACEMENT 186-23 - BID # 8028-M3

THE BIDDER MUST FILL IN THESE UNIT PRICES. Also carry out all extensions and fill in "Computed Totals."

In case of error or discrepancies, UNIT PRICES govern and written works take precedence over figures.

ITEM NUMBER AND DESCRIPTION		ESTIMATED QUANTITY	COMPUTED TOTALS
120.0000	CLASS "B" ROCK EXCAVATION AND DISPOSAL		
	_____ Dollars	612.00	\$ _____
	(\$ _____ ) CY		
122.0000	EARTH EXCAVATION BELOW NORMAL GRADE		
	_____ Dollars	612.00	\$ _____
	(\$ _____ ) CY		
125.0000	SAND BORROW		
	_____ Dollars	2,040.00	\$ _____
	(\$ _____ ) CY		
126.0000	GRAVEL BORROW		
	_____ Dollars	2,040.00	\$ _____
	(\$ _____ ) CY		
128.0000	SCREENED LOAM BORROW		
	_____ Dollars	36.00	\$ _____
	(\$ _____ ) CY		
150.0000	FURNISH AND SPREAD CALCIUM CHLORIDE		
	_____ Dollars	4,588.00	\$ _____
	(\$ _____ ) LB		
156.0000	SEEDING		
	_____ Dollars	202.00	\$ _____
	(\$ _____ ) SY		
301.0100	1" Polyethylene Tubing		
	_____ Dollars	2,795.00	\$ _____
	(\$ _____ ) LF		
301.0200	2" Copper Tubing		
	_____ Dollars	210.00	\$ _____
	(\$ _____ ) LF		

# WATER MAIN REPLACEMENT 186-23 - BID # 8028-M3

ITEM NUMBER AND DESCRIPTION	ESTIMATED QUANTITY	COMPUTED TOTALS
301.0600 6" CLDI Pipe		
	Dollars	330.00 \$
(\$ ) LF		
301.0800 8" CLDI Pipe		
	Dollars	4,185.00 \$
(\$ ) LF		
301.1200 12" CLDI Pipe		
	Dollars	2,330.00 \$
(\$ ) LF		
301.5000 Polyethylene Wrap for Ductile Iron Pipe		
	Dollars	6,980.00 \$
(\$ ) LF		
302.0808 8"x8" Cut-in Tee		
	Dollars	1.00 \$
(\$ ) EA		
302.1000 Cast or Ductile Fittings		
	Dollars	9,120.00 \$
(\$ ) LB		
302.1612 16"x12" Cut-in Tee		
	Dollars	1.00 \$
(\$ ) EA		
304.0100 VALVE BOX		
	Dollars	74.00 \$
(\$ ) EA		
304.1000 LOWER STREET SERVICE BOX		
	Dollars	29.00 \$
(\$ ) EA		
305.0200 2" Ball Valve		
	Dollars	1.00 \$
(\$ ) EA		

# WATER MAIN REPLACEMENT 186-23 - BID # 8028-M3

ITEM NUMBER AND DESCRIPTION		ESTIMATED QUANTITY	COMPUTED TOTALS
305.0600	6" Gate Valve		
		Dollars	16.00 \$
	(\$ ) EA		
305.0800	8" Gate Valve		
		Dollars	44.00 \$
	(\$ ) EA		
305.1200	12" Gate Valve		
		Dollars	12.00 \$
	(\$ ) EA		
309.1000	Service Connection		
		Dollars	105.00 \$
	(\$ ) EA		
309.2000	Service Box and Curb Stop		
		Dollars	105.00 \$
	(\$ ) EA		
309.3000	Service Box and Cut-in Curb Stop (3/4" - 1")		
		Dollars	20.00 \$
	(\$ ) EA		
310.1000	New Hydrant		
		Dollars	15.00 \$
	(\$ ) EA		
310.3000	Hydrant Removed and Stacked		
		Dollars	15.00 \$
	(\$ ) EA		
310.4000	Hydrant Removed and Reset		
		Dollars	1.00 \$
	(\$ ) EA		
311.1608	16X8 Tapping sleeve & valve		
		Dollars	1.00 \$
	(\$ ) EA		

# WATER MAIN REPLACEMENT 186-23 - BID # 8028-M3

ITEM NUMBER AND DESCRIPTION	ESTIMATED QUANTITY	COMPUTED TOTALS
312.0600 6" Tie-in		
_____ Dollars	3.00	\$ _____
(\$ _____) EA		
312.0800 8" Tie-in		
_____ Dollars	25.00	\$ _____
(\$ _____) EA		
312.1200 12" Tie-in		
_____ Dollars	2.00	\$ _____
(\$ _____) EA		
312.1600 16" Tie-in		
_____ Dollars	1.00	\$ _____
(\$ _____) EA		
313.2000 Thrust Block		
_____ Dollars	63.00	\$ _____
(\$ _____) EA		
314.2000 1" Blow Off		
_____ Dollars	1.00	\$ _____
(\$ _____) EA		
314.5000 DIG AND PLUG EXISTING CONNECTION 3" AND LARGER		
_____ Dollars	1.00	\$ _____
(\$ _____) EA		
316.0200 Temporary 2" By-Pass		
_____ Dollars	4,380.00	\$ _____
(\$ _____) LF		
316.0400 Temporary 4" By-Pass		
_____ Dollars	6,570.00	\$ _____
(\$ _____) LF		
317.0000 Temporary Taps on Service Laterals		
_____ Dollars	12.00	\$ _____
(\$ _____) EA		

# WATER MAIN REPLACEMENT 186-23 - BID # 8028-M3

ITEM NUMBER AND DESCRIPTION		ESTIMATED QUANTITY	COMPUTED TOTALS
416.0000	CURB REMOVE AND RESET		
		Dollars	246.00 \$
	(\$ ) LF		
430.0000	EXISTING BITUMINOUS CONCRETE DRIVEWAY REPAIR		
		Dollars	4.00 \$
	(\$ ) SY		
432.0000	EXISTING BITUMINOUS CONCRETE SIDEWALKS REPAIR		
		Dollars	74.00 \$
	(\$ ) SY		
436.0000	RESURFACE TRENCHES TEMPORARY		
		Dollars	9,235.00 \$
	(\$ ) LF		
436.0100	RESURFACE TRENCHES PERMANENT		
		Dollars	3,950.00 \$
	(\$ ) LF		
438.5000	BITUMINOUS CONCRETE BERM REPAIR		
		Dollars	140.00 \$
	(\$ ) LF		
442.0000	CONCRETE SIDEWALK REPAIR		
		Dollars	31.00 \$
	(\$ ) SY		
446.3000	EXCAVATABLE CONTROL DENSITY FILL (CDF)		
		Dollars	83.00 \$
	(\$ ) CY		
900.0000	Lump Sum Reserve		
	five hundred thousand and xx / 100	Dollars	\$ 500,000.00
912.2019	TEST HOLE EXCAVATION & BACKFILL		
		Dollars	1.00 \$
	(\$ ) EA		

# WATER MAIN REPLACEMENT - BID # 8028-M3

ITEM NUMBER AND DESCRIPTION	ESTIMATED QUANTITY	COMPUTED TOTALS
953.2020 SILT SACK		
	Dollars	66.00
		\$
(\$	) EA	

TOTAL BID PRICE INCLUDING CONTINGENCY

\_\_\_\_\_Dollars                      and                      \_\_\_\_\_Cents  
(amount in words)

\$ \_\_\_\_\_  
(amount in figures)

This proposal is based on provisions of the following addenda:

No. \_\_\_\_\_

No. \_\_\_\_\_

No. \_\_\_\_\_

No. \_\_\_\_\_

All amounts and totals given above will be subject to verification by the City. In case of variation between Unit Bid Price and Totals shown by the Bidder, the Unit Price written in words will be considered to be the bid.

The City reserves the right to reject any and all bids, wholly or in part, and to make awards in a manner deemed in the best interests of the City.

The above estimated quantities form an approximate statement of the extent of the work to be done, based upon the estimate of the Contracting Officer. The City does not expressly or by implication agree that the actual quantity of work will correspond therewith, but reserves the right to increase or decrease the quantity of any class or portion of the work, as may be deemed necessary by the Contracting Officer.



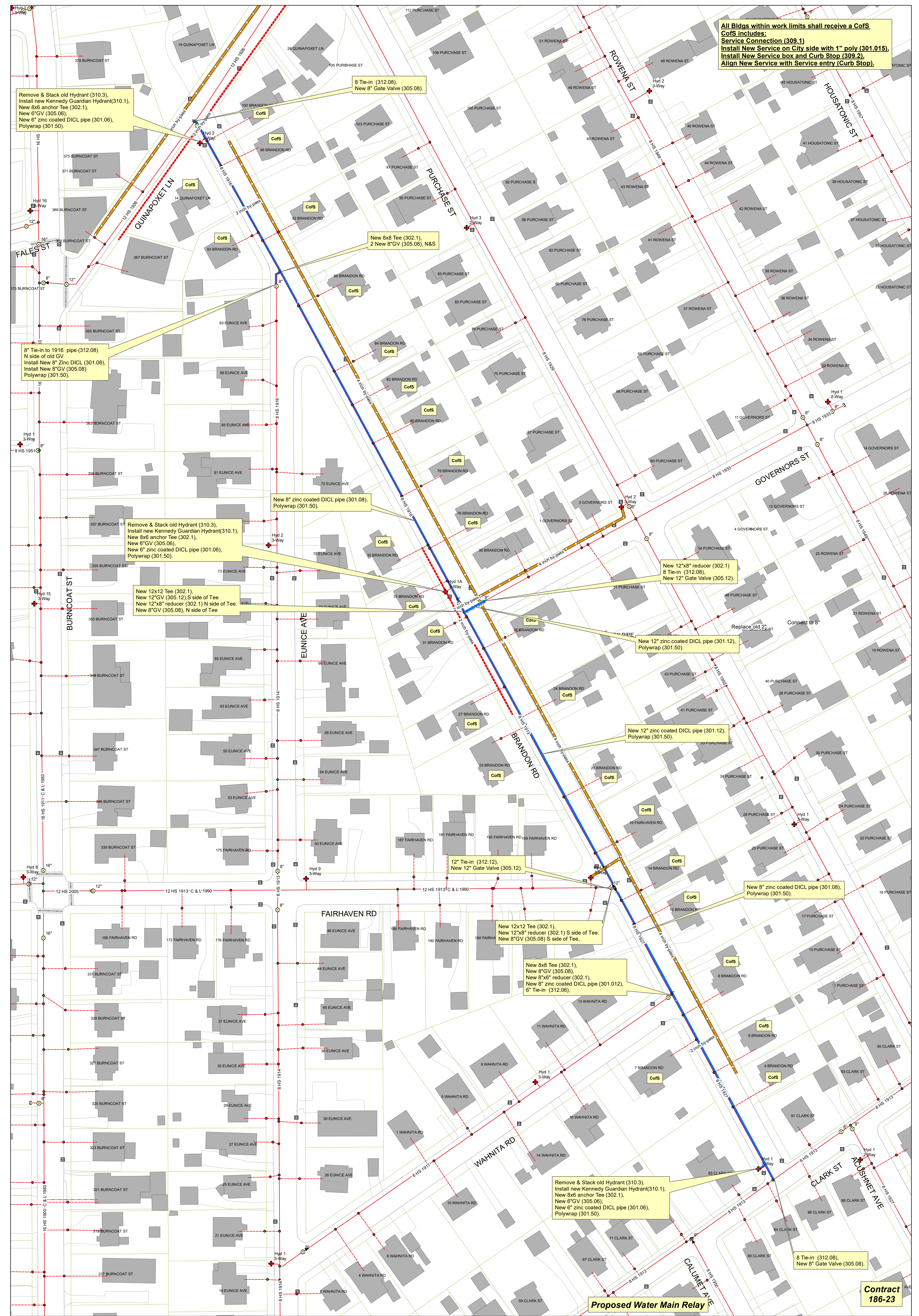



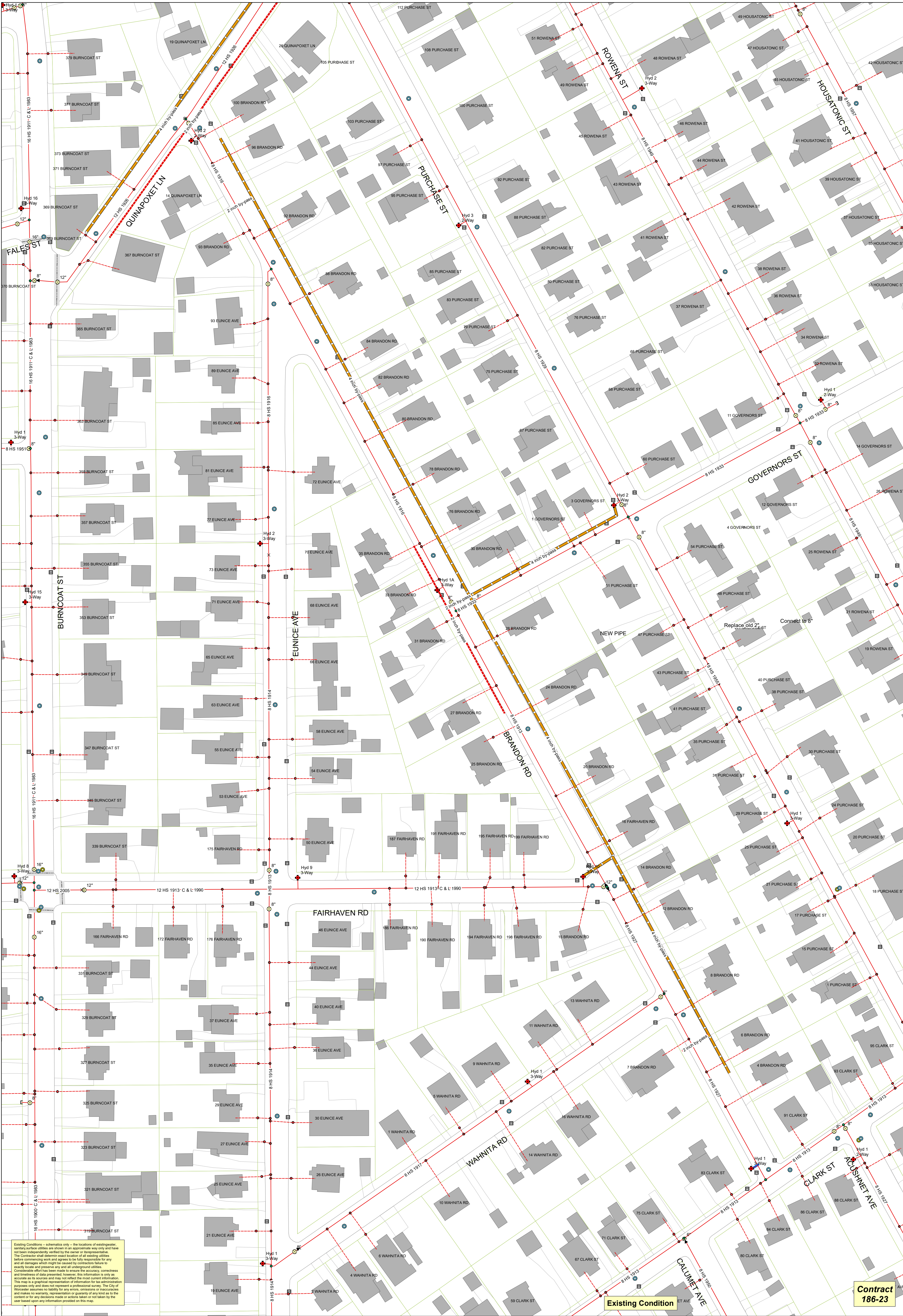

BRANDON RD (Clark St to Quinapoxet Ln)  
Relay 1150' of 8" 1916, 1927 Pipe with new 8" Zinc Coated CLDI Pipe  
and 430' of 8" 1913 with new 12" Zinc Coated CLDI Pipe

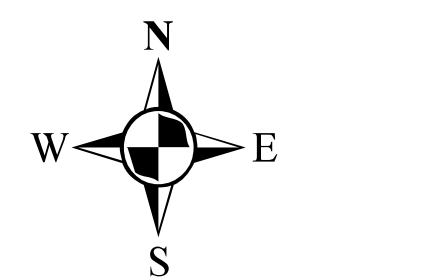

Contract  
186-23



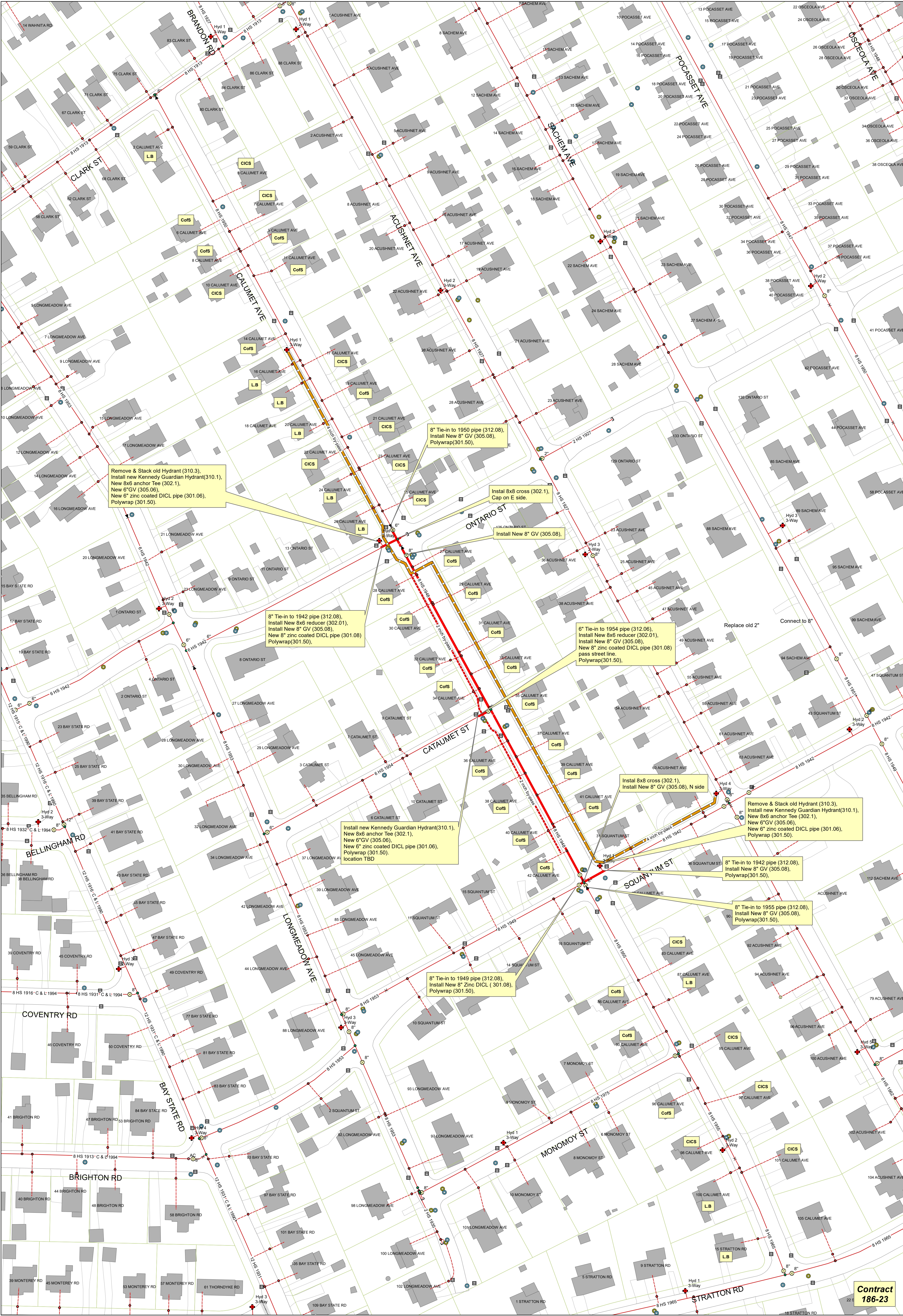



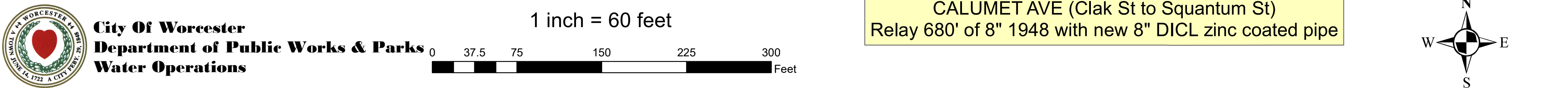



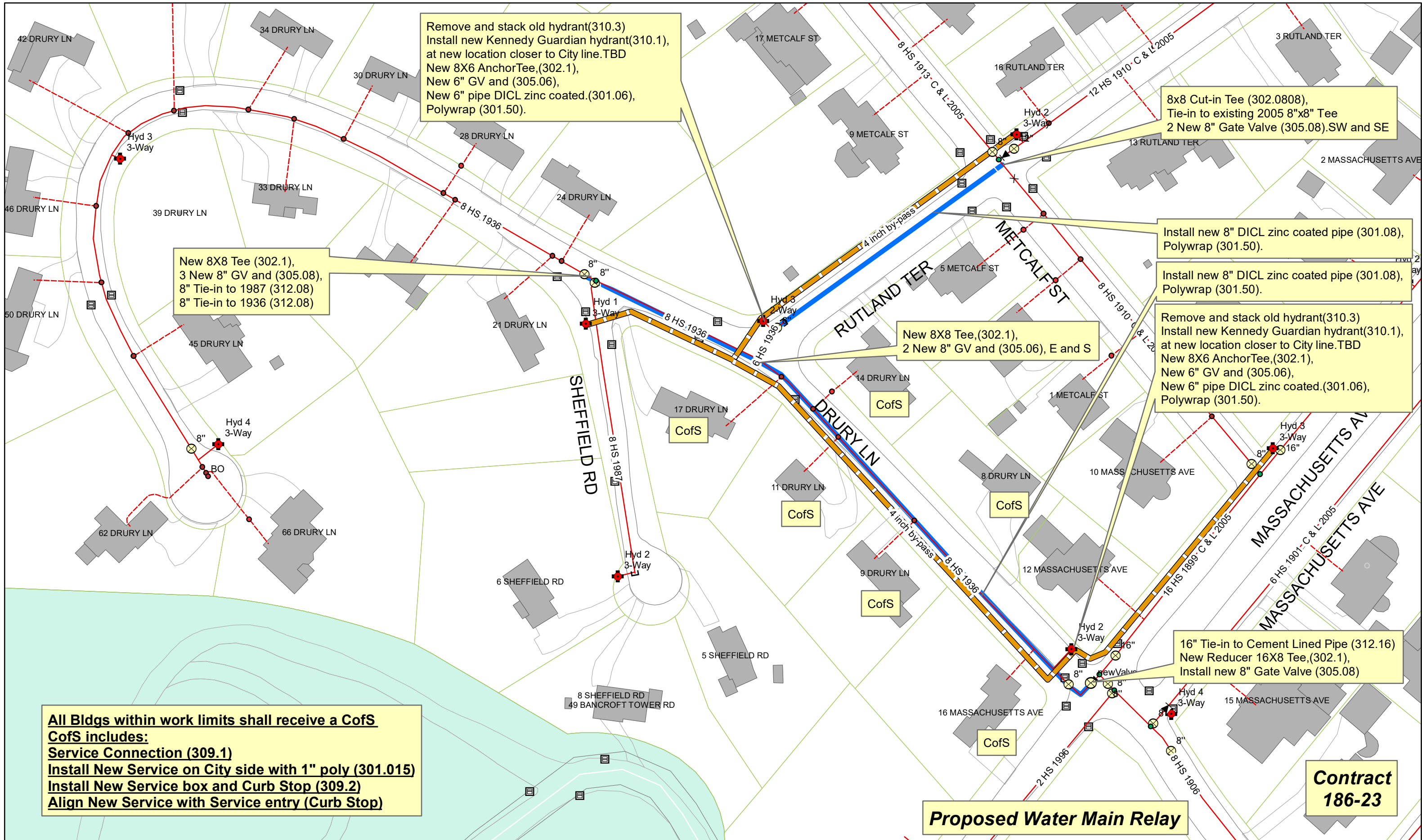

**City Of Worcester  
Department of Public Works & Parks  
Water Operations**

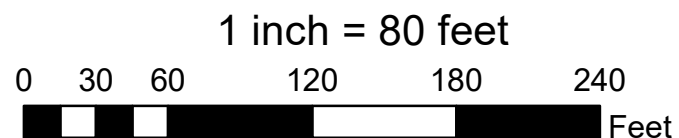

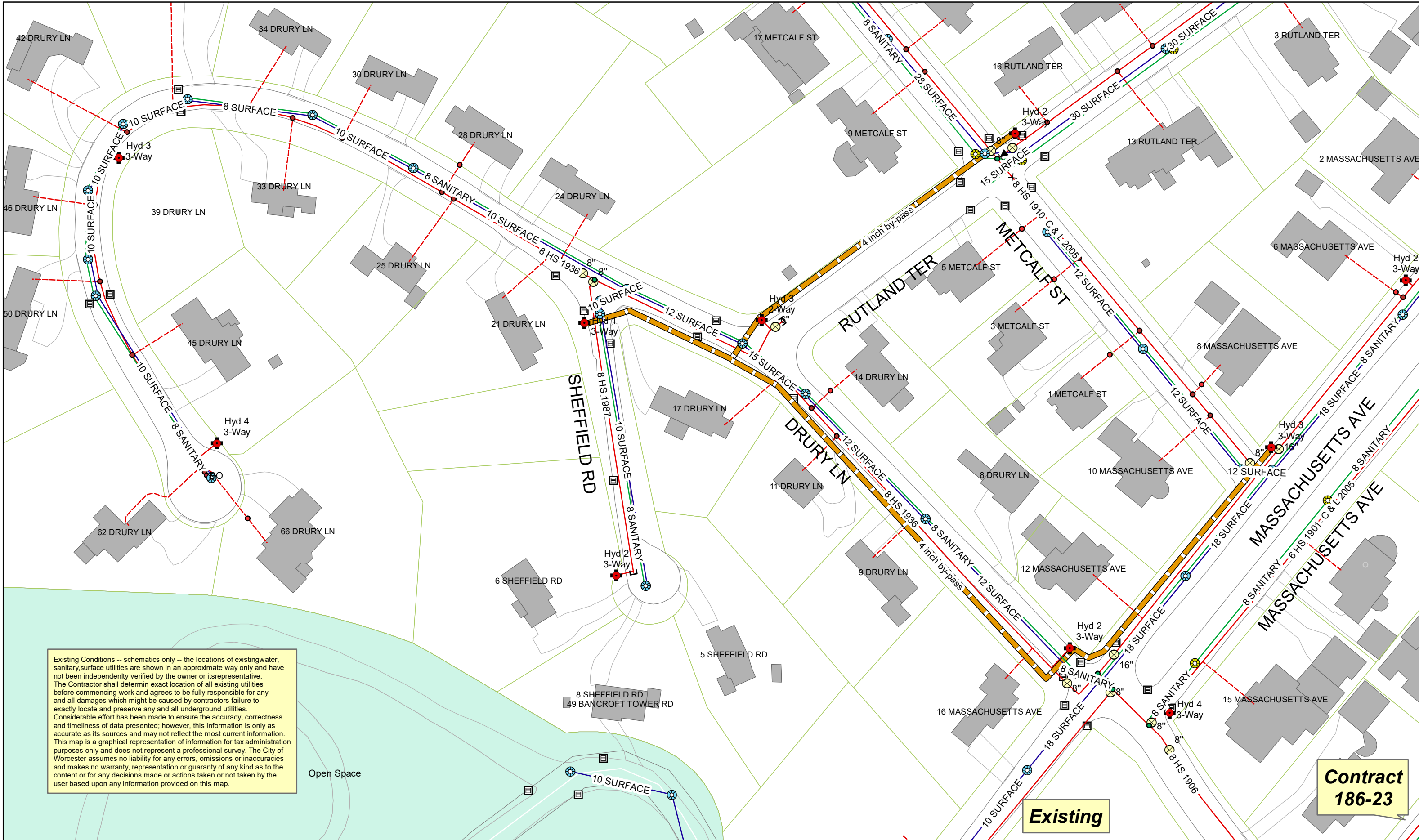

**City of Worcester**  
**Department of Public Works & Parks**  
**Water Operations**

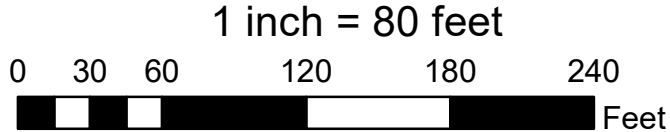

**DRURY LN and RUTLAND TER**  
**Install 930' of new 8" DICL pipe**





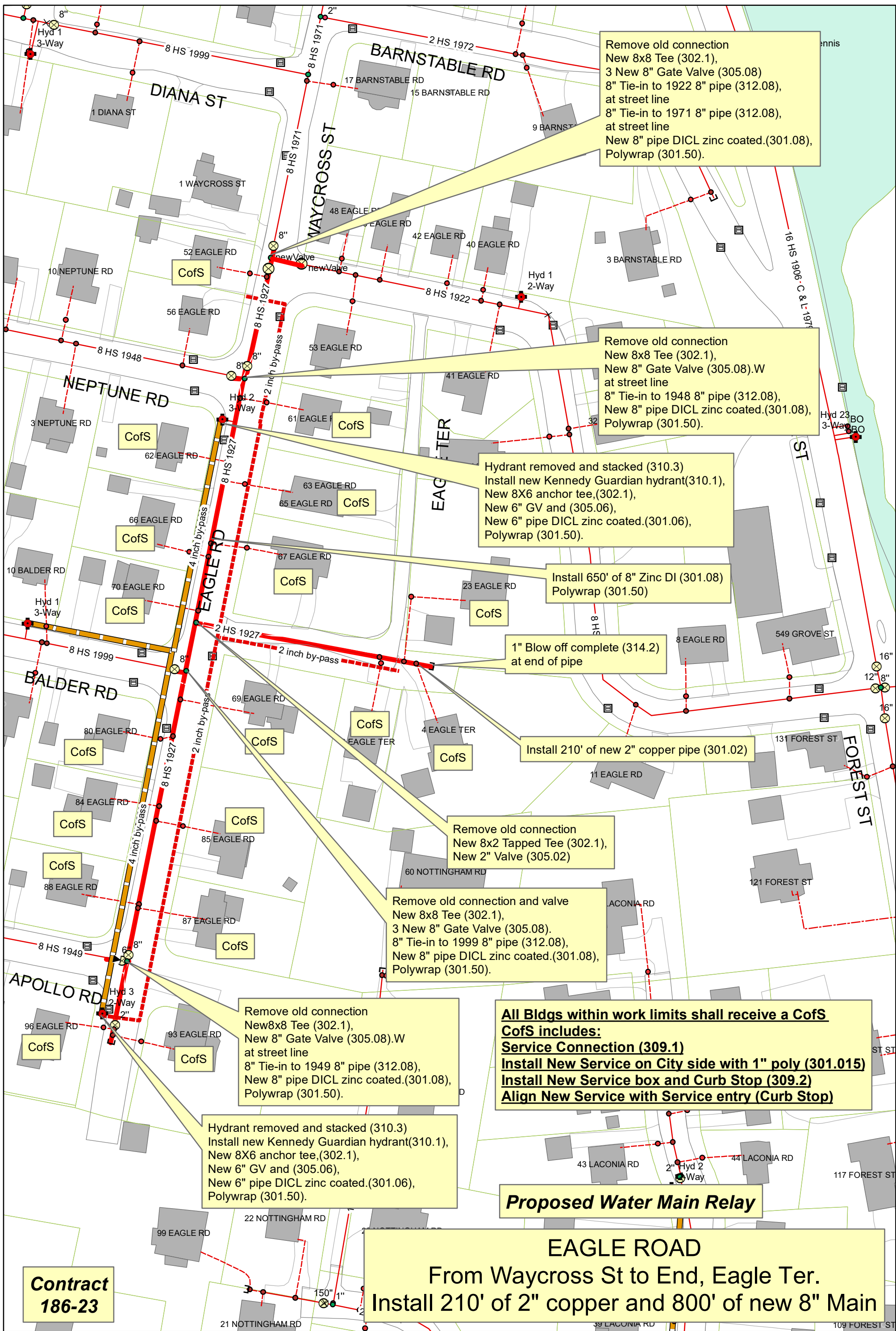

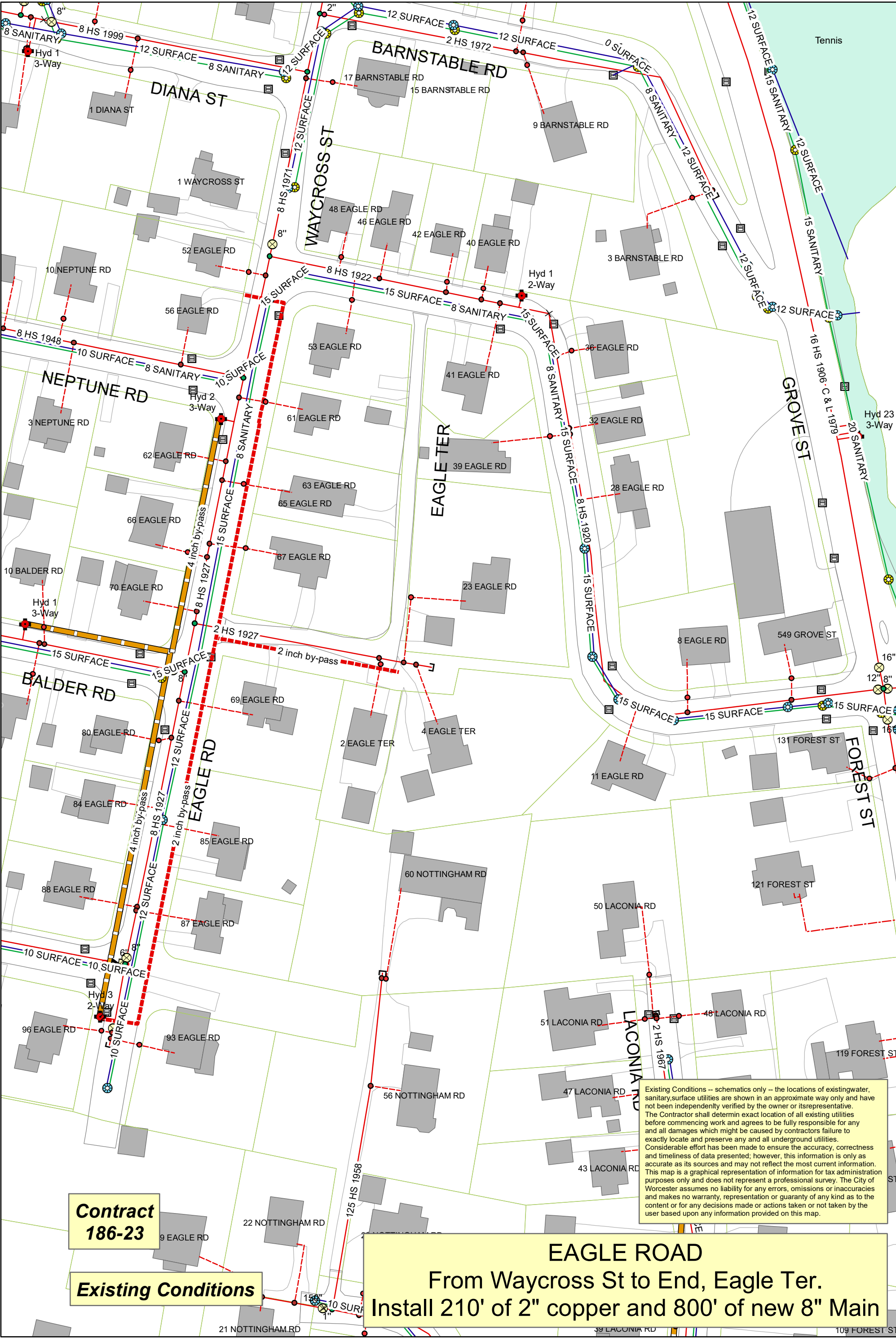

**City Of Worcester**  
**Department of Public Works & Parks**  
**Water Operations**

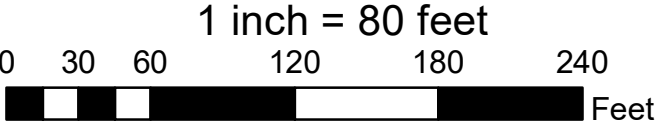



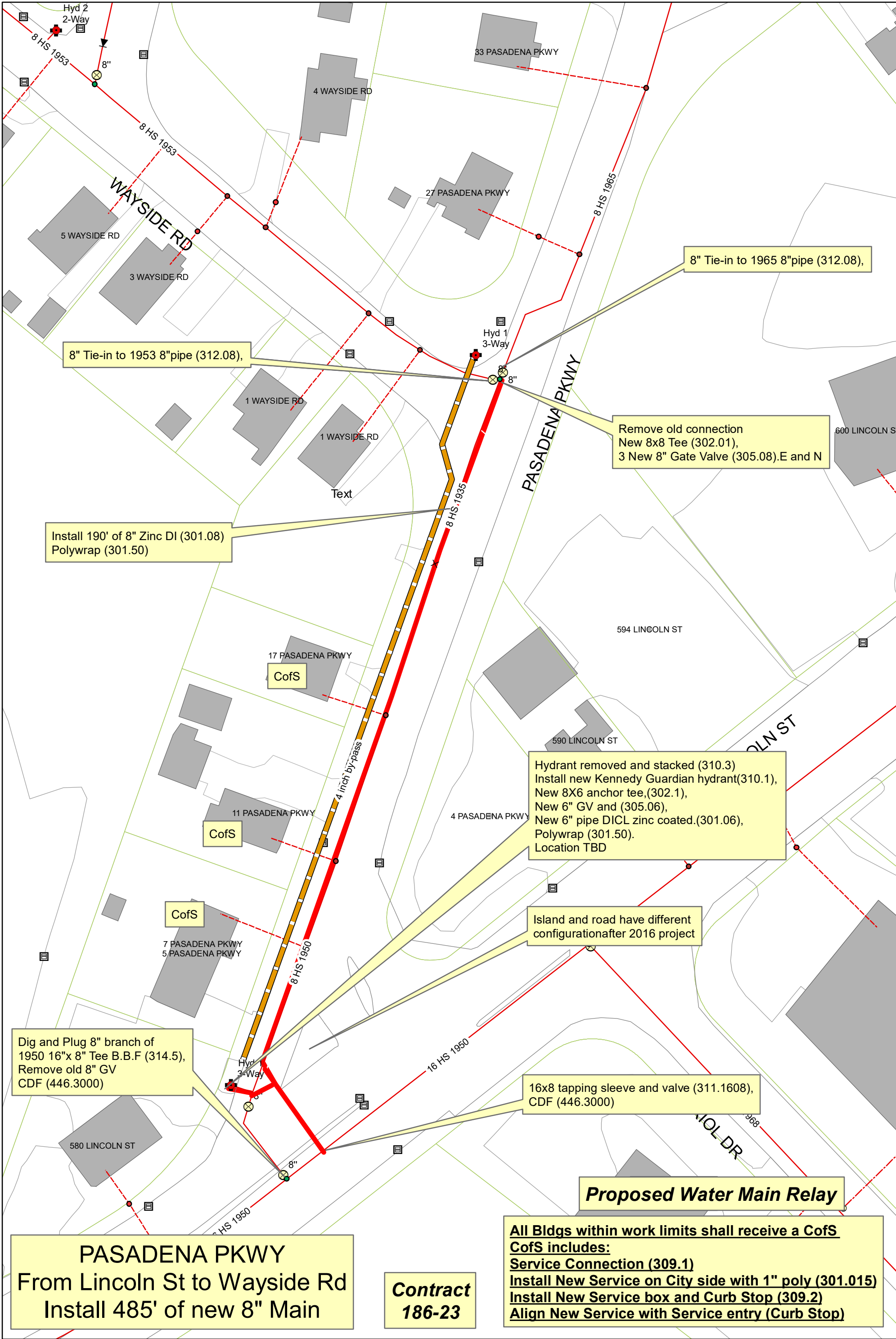



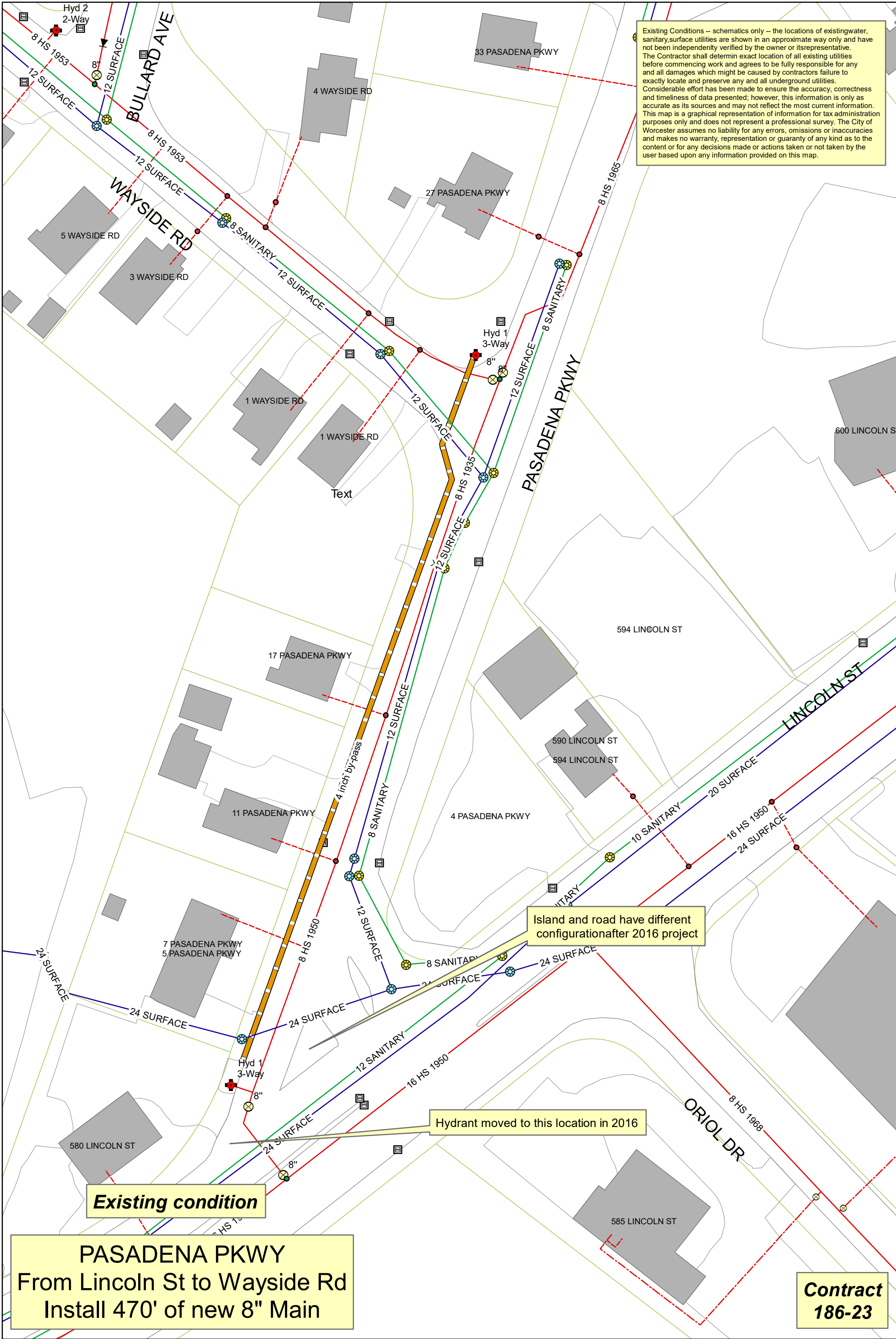

**City Of Worcester**  
**Department of Public Works & Parks**  
**Water Operations**

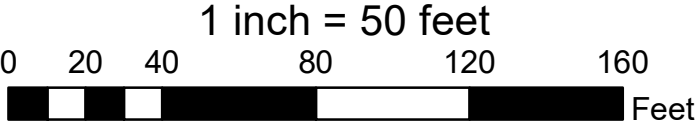



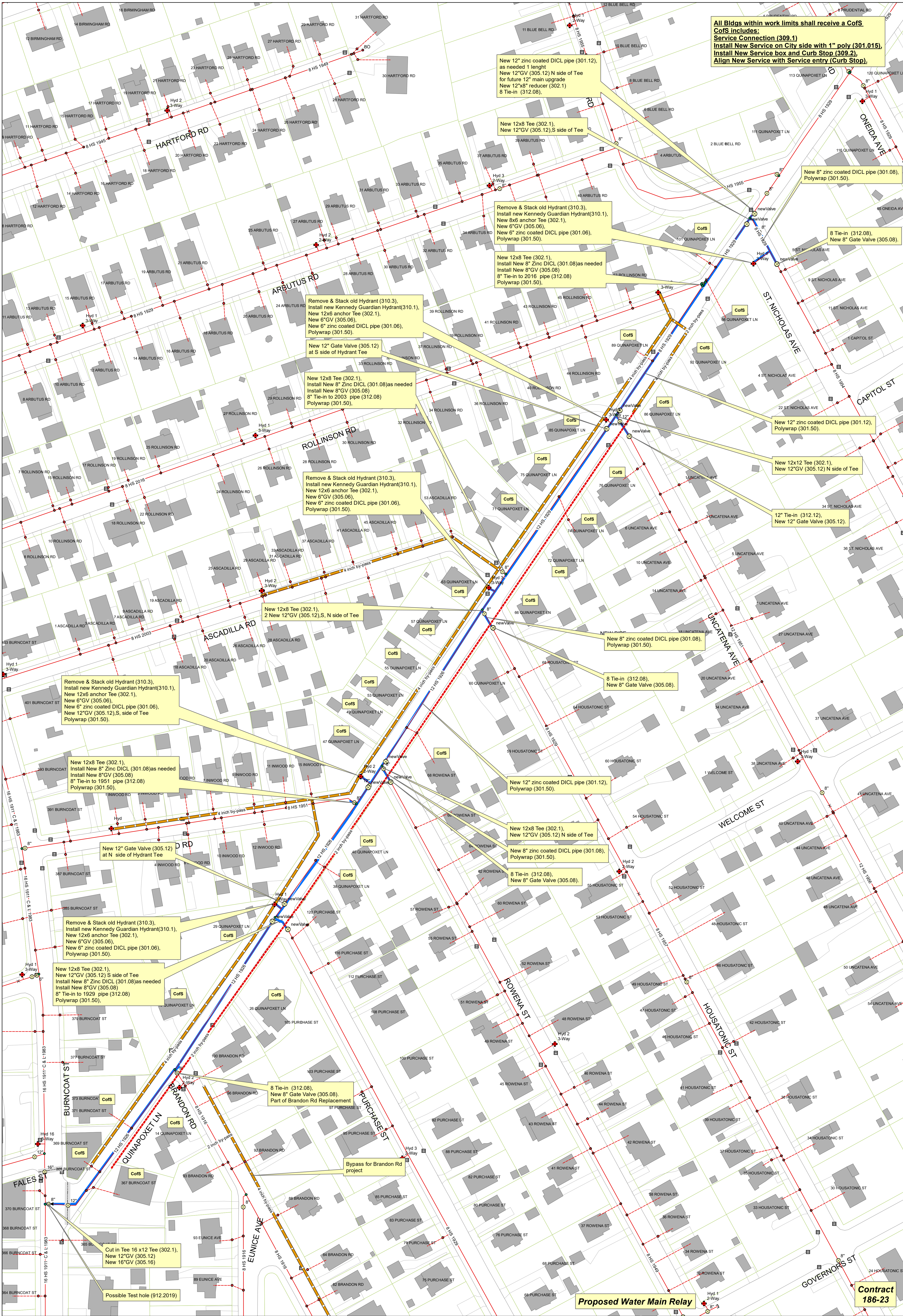

QUINAPOXET LN  
(Burncoat St to St. Nicholas Ave)  
Relay 1900' of 12" and 8" 1929 Pipe  
with new 12" Zinc Coated CLDI Pipe

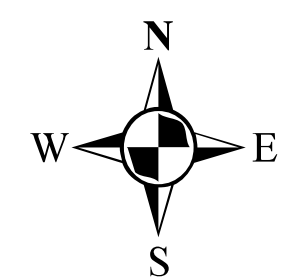





**City Of Worcester**  
**Department of Public Works & Parks**  
**Water Operations**

1 inch = 60 feet

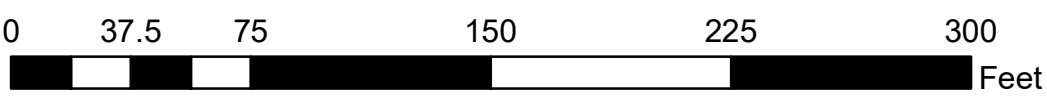

**QUINAPOXET LN**  
(Burncoat St to St. Nicholas Ave)  
Relay 1900' of 12" and 8" 1929 Pipe  
with new 12" Zinc Coated CLDI Pipe

