



The City of  
**WORCESTER**

Administration & Finance – Purchasing Division  
Christopher J. Gagliastro, MCPPO – Purchasing Director  
455 Main Street, Room 201, Worcester, MA 01608  
P | 508-799-1220  
[purchasing@worcesterma.gov](mailto:purchasing@worcesterma.gov)

May 12, 2022

To All Bidders:

Subject: **Bid No. 7800-W2, Coal Mine Brook Site Improvements / DPWP**

**ADDENDUM NO. 2**

To Whom It May Concern:

With reference to our bid request relative to the above subject, please refer to the changes/modifications/clarifications to the original proposal request.

- **PLEASE SEE ATTACHED GENERAL BID CLARIFICATIONS AND QUESTIONS RECEIVED AND RESPONSES FROM CITY**

Bidders are requested to acknowledge and/or include this addendum with bid. All other terms, conditions and specifications remain unchanged.

Very truly yours,

Christopher J. Gagliastro  
Purchasing Director

## **ADDENDUM NUMBER TWO**

**Date:** May 12, 2022  
**Project:** Coal Mine Brook Site Improvements  
City of Worcester Dept. of Public Works and Parks; Parks, Recreation and Cemetery Div.

### **General Bid Clarifications:**

1. Water utility cabinet to shall be size to contain water meter, backflow and fittings and appurtenances sized for 1" service, as per DPW Water Standards. Furnish and install additional adjacent single door cabinet of identical construction (1'-8"H X 2'-3"D X 20"W), relocate hose bib to this cabinet. Adjust size of (18" thick) concrete pad to accommodate both cabinets.

### **General Bid Questions:**

**Question1:** Who is responsible for the "Standard Park Signs"?  
**Answer:** **Contractor is responsible to furnish one 48"x48" and one 48"x96" Standard Park Sign as located by Ownwer. See Attachments.**

**Question2:** There is not a specification section describing the "Alternates". The work of the Alternates appears on the Bid Form. On the Lay-Out plan, the P.I.P Safety Surfacing is indicated to be "Alternate 1", and P.I.P. Safety Surfacing for the playground equipment is indicated to be "Alternate 2". Are the "Precast Concrete Curbs to be included in the alternates? Are the "Concrete Pads" for the picnic tables and benches to be included in the alternates? Please clarify.

**Answer:** **Refer to SKA-1 and SKA-2.**

**Question3:** Are there any details for the interpretive signs? Did not see anything on the bid docs.  
**Answer:** **No details provided in Bidding Documents, carry allowance of \$5,000 in Base Bid to furnish and install interpretive sign(s). Design and Specifications will be provide by Owner after Award of Bid.**

**Question4:** Are compost socks a suitable substitution for hay bales on the erosion control barrier.  
**Answer:** **Substitution or equals are addressed after Award of Bid and during shop drawing review.**

**Question5:** What is the estimate timeframe for the existing utility pole and wires to be relocated? Who is responsible for payment of the National Grid charges for the new electrical service? Is National Grid responsible for the relocation of utility pole No. 165-1?  
**Answer:** **Owner is in the process of payment of pole relocation work by National Grid. It is anticipated that the relocation work will occur during the construction period for this Project. Contractor is responsible to coordinate and accommodate relocation with National Grid.**

Question6: Please specify the wire size feeding the light poles.  
Answer: **Refer to Sheet E-4, Detail "Typical Walkway Light Wiring Diagram, #4 Cu on the main line, fused taps feeding #12 Cu to the individual light poles.**

Question7: Will alternate modular block wall face, other than ledgerstone, be considered?  
Answer: **For the purpose of base bid, replace "ledgerstone" style modular wall system with "cobblestone" style modular wall system as manufactured by "Redi-Rock". Substitution or equals are addressed after Award of Bid and during shop drawing review.**

**Attachments:**

Project Standard Park Sign 4X4 (one page)  
Project Standard Park Sign 4X8 (one page)  
SKA-1  
SKA-2  
Dynamic Stone Blend/Compacted aggregate for Poured in Place (PIP) Safety Surfacing.

**END OF ADDENDUM TWO**

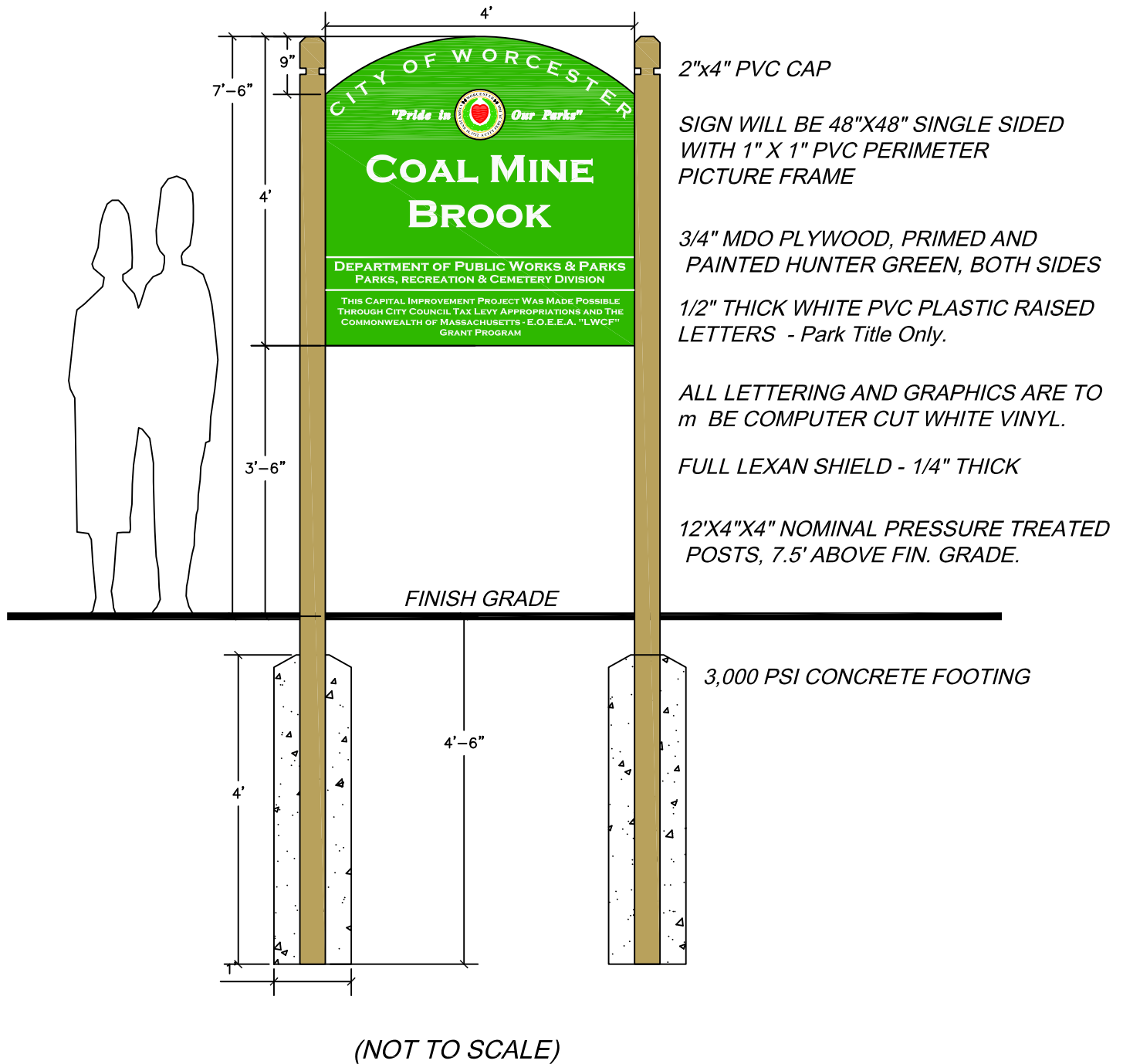

## Standard Park Permanent Sign 4'x4'

CITY OF WORCESTER DPW & PARKS - Parks, Recreation and Cemetery Division

SIGN WILL BE 96"X48" SINGLE SIDED WITH  
1"X1" PVC PLASTIC PERIMETER PICTURE  
FRAME

3/4" MDO PLYWOOD, PRIMED AND PAINTED  
HUNTER GREEN, BOTH SIDES.

1/2" THICK WHITE PVC PLASTIC RAISED  
LETTERS – Park Title Only.

ALL LETTERING AND GRAPHICS ARE TO BE  
COMPUTER CUT WHITE VINYL.

FULL LEXAN SHIELD – 1/4" THICK

12'X6"X6" NOMINAL DIRECT BURIED  
PRESSURE TREATED POSTS, 8.0' ABOVE FIN.  
GRADE.

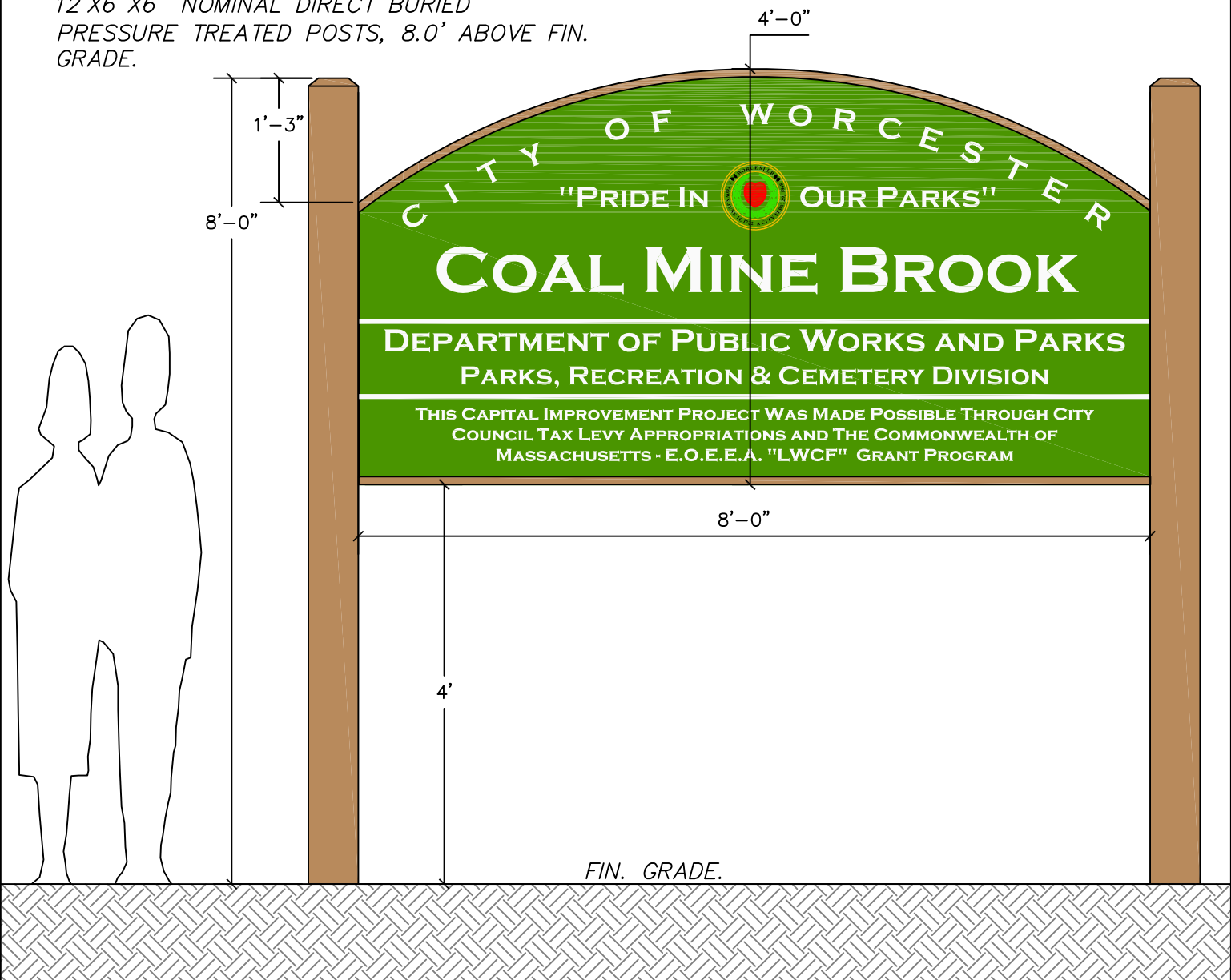

## Standard Park Permanent Sign 4'X8'

CITY OF WORCESTER DPW & PARKS - Parks, Recreation and Cemetery Division

Base Bid; Loam and Seed to limits of Hatch Area

Add Alternate #1 ;  
With in Limits of hatched Area, furnish and  
install Outdoor Fitness Equipment,  
Subgrade, Required Reinforced Concrete  
Pad, Safety Surfacing and Site Furnishings.  
Refer to Article, 39, 40 and 43 of Project  
Special Conditions and Bid Drawings.

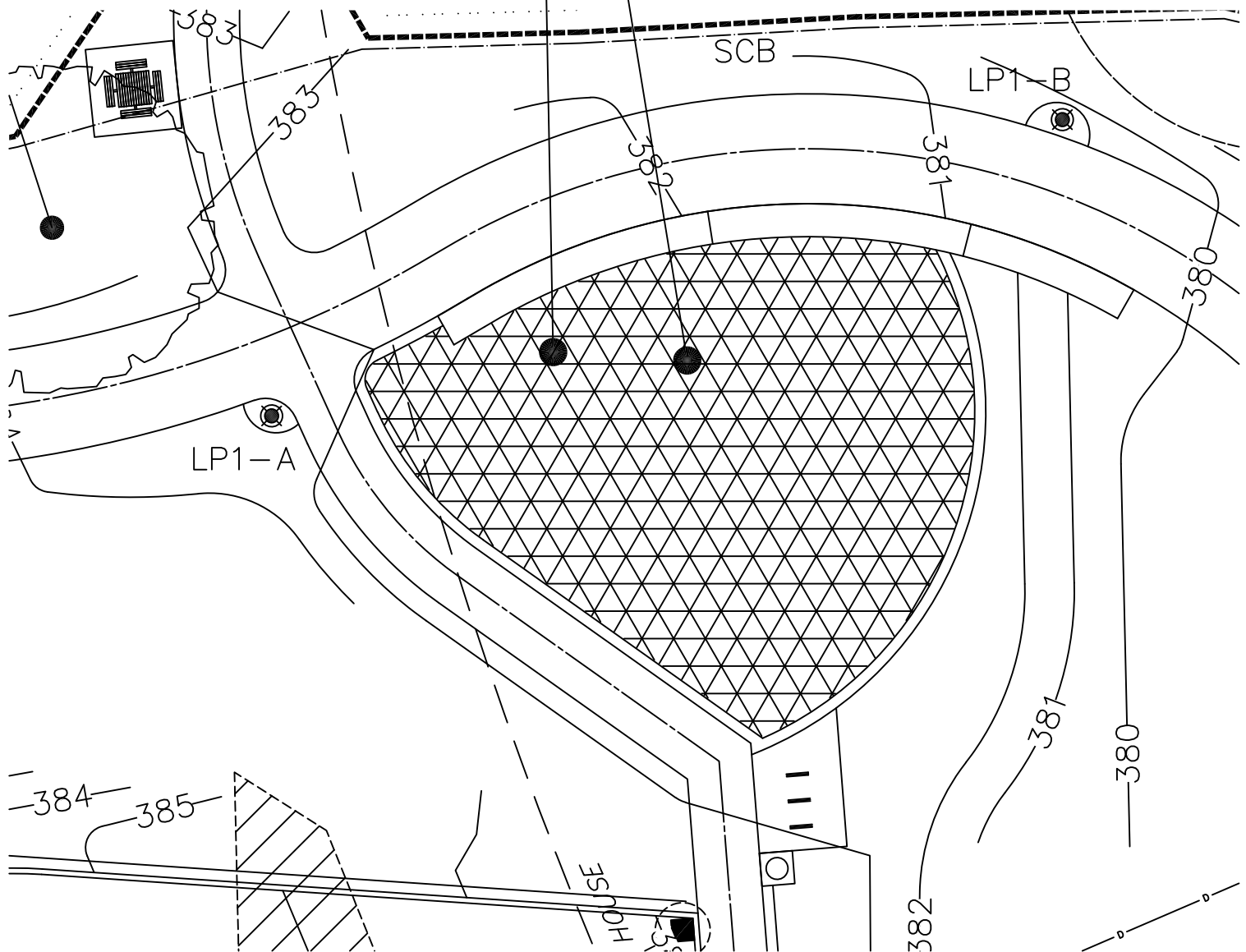

# SKA-1 Add Aternate # 1 Limit of Work

CITY OF WORCESTER DPW & PARKS - Parks, Recreation and Cemetery Division

Base Bid; Loam and Seed to limits of Hatch Area

Add Alternate #2 ;  
With in Limits of hatched Area, furnish and  
install Playground Equipment, Safety  
Surfacing, Subgrade and Site Furnishings.  
Refer to Article, 39, 40 and 43 of Project  
Special Conditions and Bid Drawings.

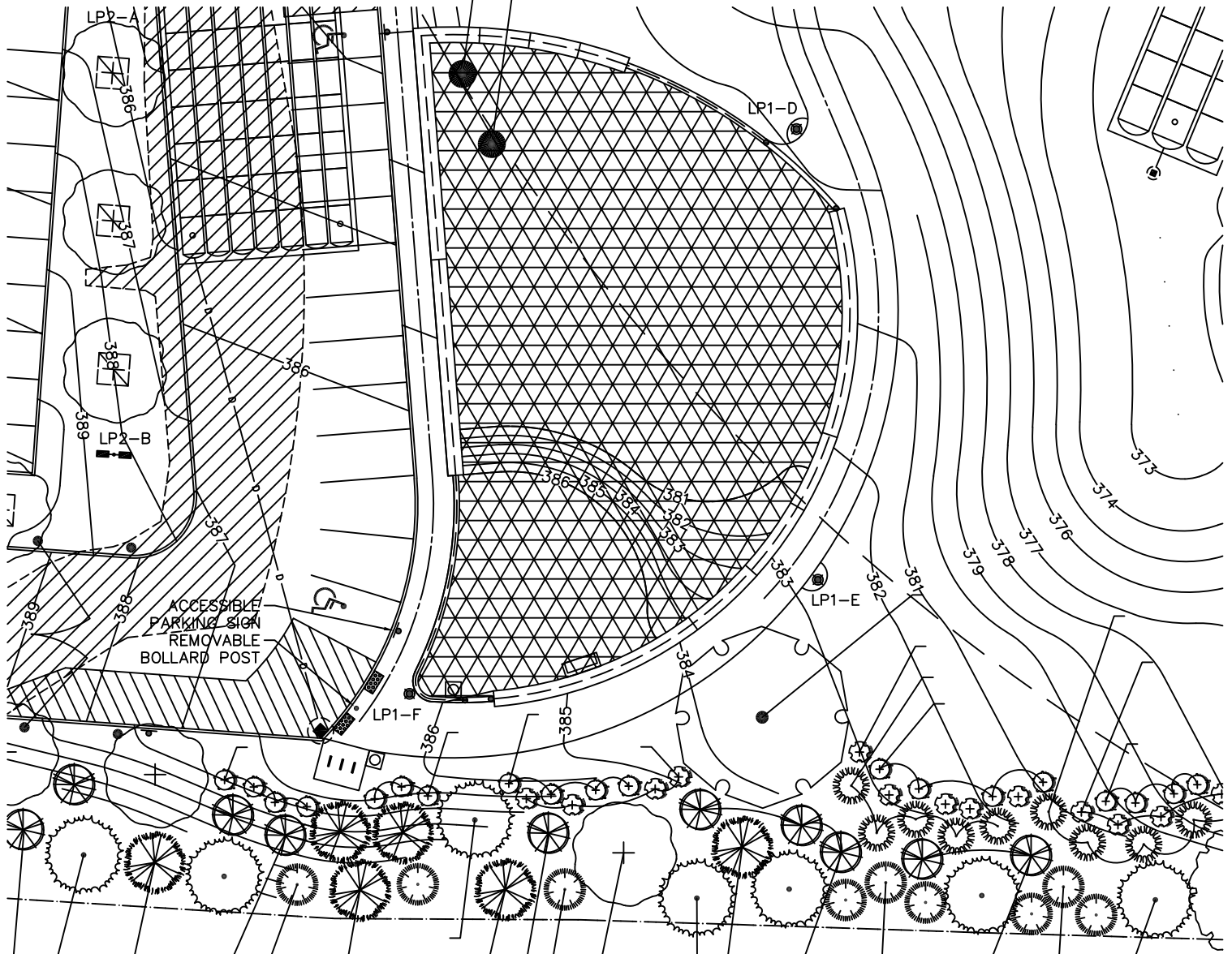

## SKA-2 Add Aternate # 2 Limit of Work

CITY OF WORCESTER DPW & PARKS - Parks, Recreation and Cemetery Division

# JSL MATERIALS, INC.

John S. Lane & Son Inc. JSL Asphalt, Inc.

## Particle Size Distribution Report

Sieve Size	Weight	% Passing	Spec	% Retained
2"		100.0		0.0
1 1/2"		100.0		0.0
1"	0	100.0	100.0	0.0
3/4"	0.62	96.3	90-95	3.7
1/2"	2.57	81.2	55-90	18.8
3/8"	3.22	62.2	45-75	37.8
1/4"	3.48	41.7		58.3
# 4	2.98	24.1	32-52	75.9
# 8	3.05	6.1		93.9
# 10	0.15	5.2	20-35	94.8
# 16	0.24	3.8	15-27	96.2
# 30	0.15	2.9		97.1
# 40	0.05	2.7	7-17	97.3
# 50	0.02	2.5		97.5
# 60	0.02	2.4		97.6
# 100	0.05	2.1	2-8	97.9
# 200	0.07	1.7	0-2	98.3
Pan	0.29			

Total 16.96

Material Type: Dynamic Base

Source: Plant # 8

Sampled By: LG

Test By: LG

Comments:

Sample Reduction Factor of 2.44

Washed Sieve Analysis

NETTCP

Certification # 264