





# INDIAN LAKE PARK: COMMUNITY ENGAGEMENT AND EDUCATIONAL SPACES

## PURPOSE

The park's design purpose is to create outdoor rooms for community engagement and education. These active spaces include a community garden, compost site, history mural, and varying levels of gathering spots. A series of curving pathways organize and connect these spaces while improving accessibility to Indian Lake's shoreline and acknowledging adjacent residential concerns. Swales direct stormwater runoff towards the natural low point and all surfaces use permeable materials, namely ADA-compliant gravel, concrete pavers, and grass lawn. All plantings are native, including a section featuring oak-hickory hardwood forest, and provide connective wildlife habitats.

## PARTI DIAGRAMS

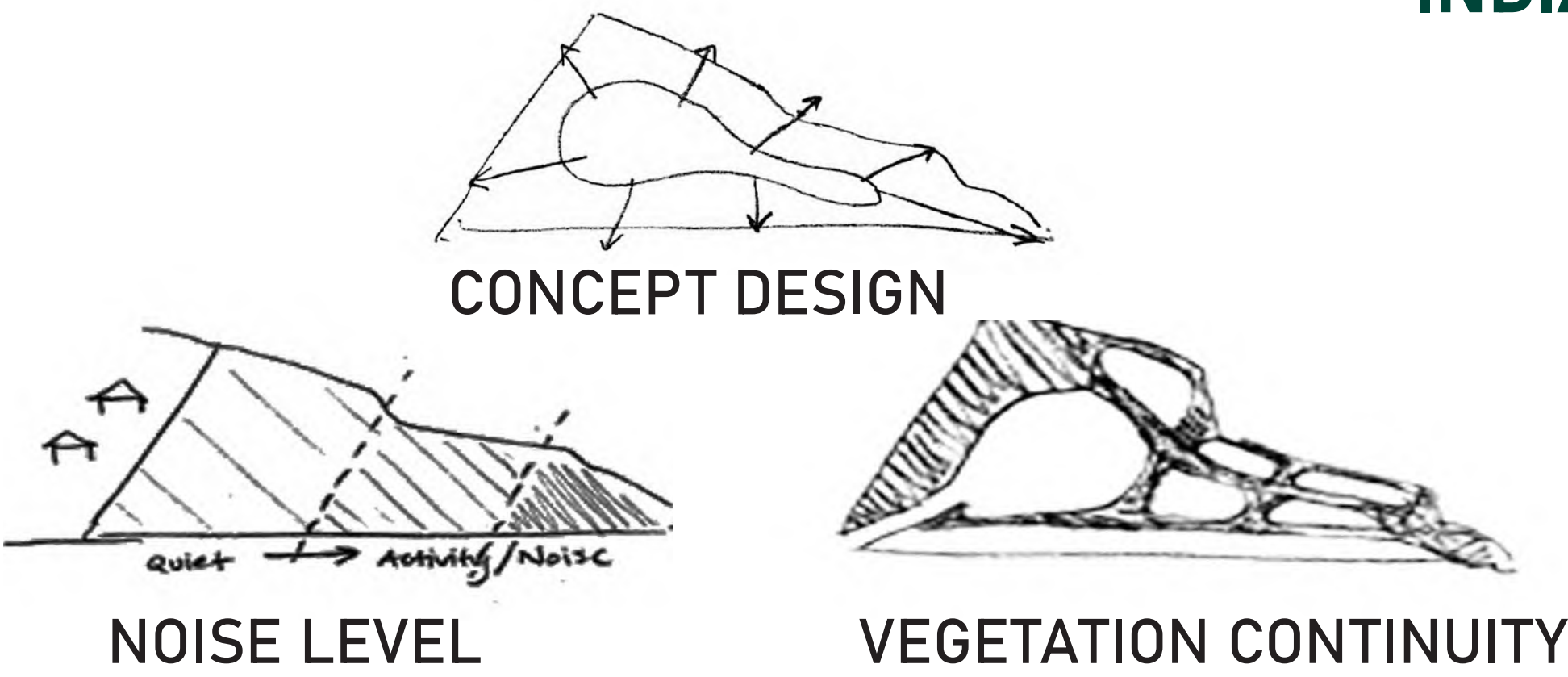

## CONNECTION TO INDIAN LAKE LOOP

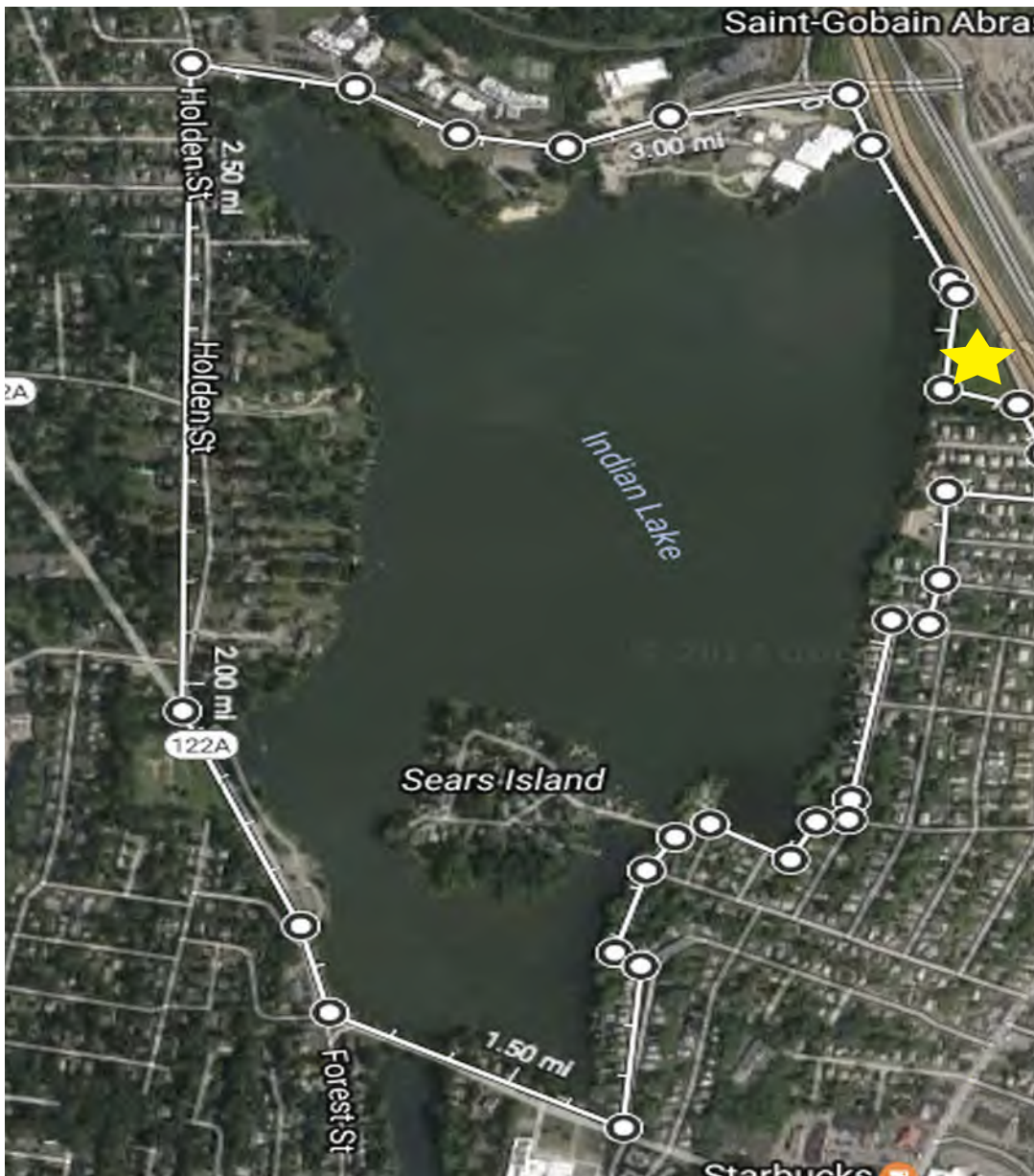

## MASTER PLAN



## PROGRAM

1. Parking Lot
2. Recreation Fields
3. Woodland Walk
4. Community Garden and Compost Site
5. Small Gazebo
6. Large Open Shelter
7. Picnic Area
8. Boat Ramps
9. Shoreline Walk
10. Playground/Workout Area
11. Bike Parking
12. History Mural



# CIRCULAR MEADOWS PARK ON INDIAN LAKE

MATT VELASQUEZ, KEEGAN O’KEEFE, VIKTOR SCHNEIDER

WORCESTER, MA





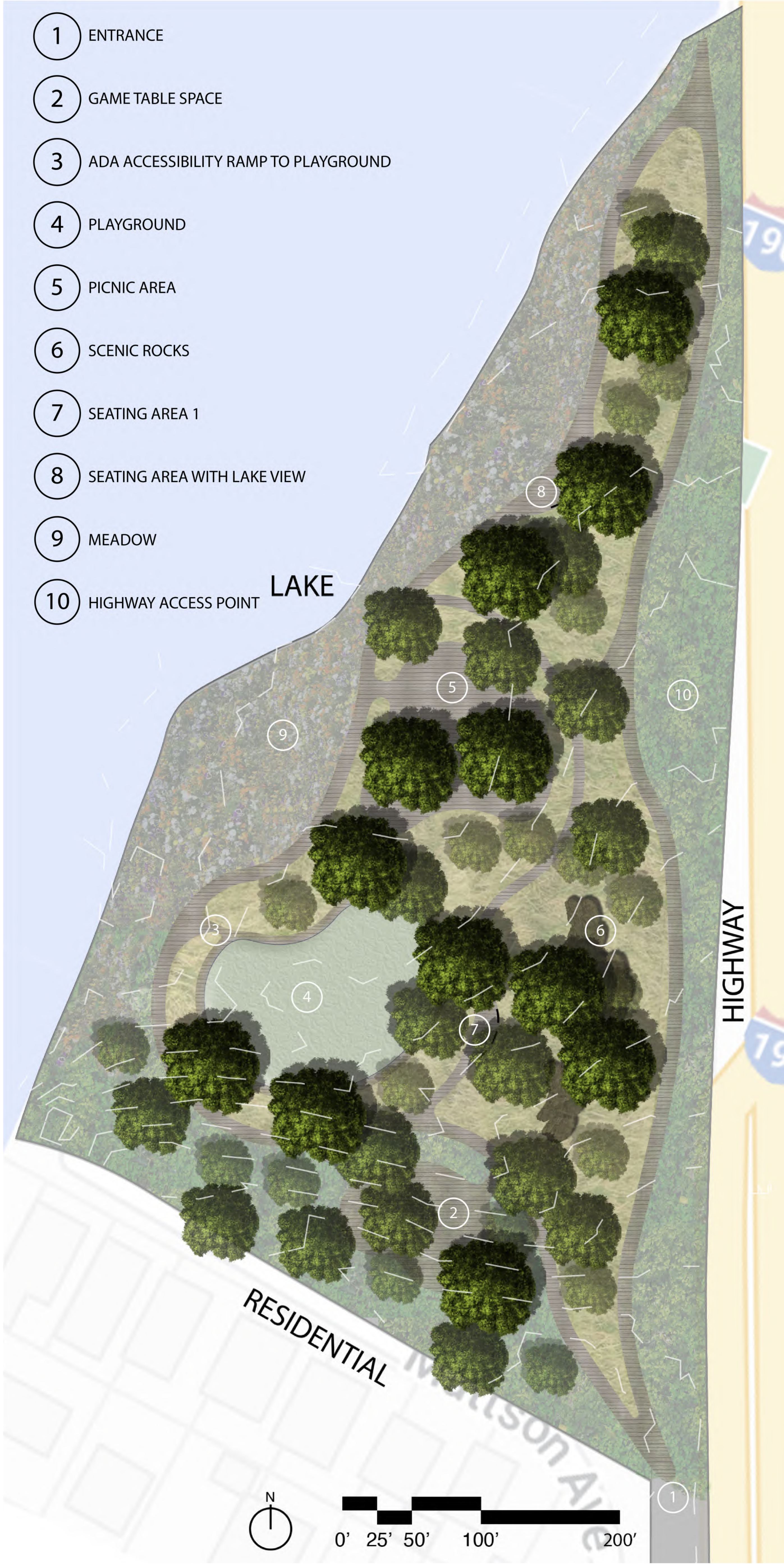

SITE INTRODUCTION:

THIS SITE DESIGN USES NATURAL, LOCALLY SOURCED MATERIALS THAT REFLECTS THE NATURAL ENVIRONMENT.

THERE ARE THREE MAIN SPACES, WHICH INCLUDE AN AREA WITH GAME TABLES, A PASSIVE PLAYGROUND SPACE AND PICNIC AREA. THERE ARE TWO SEATING AREAS ALONG THE PATHS, THAT PROVIDE PEOPLE WITH OPPORTUNITIES FOR RESTING. THE ENTIRE SITE IS ADA ACCESSIBLE WITH WALKWAYS THAT ARE 6’WIDE. THE PLAYGROUND HAS A RAMP WITH A 2% SLOPE INTO THE SPACE AND THE INNER PORTION OF THE AREA IS MADE FROM PERMEABLE POURED IN PLACE RUBBER. THE PICNIC AREA HAS NATURAL WOOD TABLES WITH WOODEN SEATS AND SPACE FOR WHEELCHAIRS AND STROLLERS.

SEATING IS SEEN ALONG THE BOARDWALK, WHICH HAS GAPS BETWEEN BENCHES FOR ADA ACCESSIBILITY.

THE PATHS ARE RAISED WOODEN BOARDWALKS 2’ ABOVE GROUND LEVEL TO ACCOUNT FOR THE SITE BEING A FLOODPLAIN. THE PATHS ARE BIOMORPHIC TO REFLECT A NATURAL FORM. ALONG THE HIGHWAY, THERE IS A 30’ BUFFER FOR HIGHWAY MAINTENANCE WITH HARDY, DURABLE GROUND-COVER IN THAT ZONE. THERE ARE SCENIC ROCK STRUCTURES BETWEEN THE HIGHWAY AND PLAYGROUND SPACE, WHICH AIM TO REDUCE NOISE WITHIN THE SITE.

PLANTING LIST:

- GROUND COVERS & GRASSES
- NEW ENGLAND WILDFLOWER MIX
  - FESTUCA RUBRA, RED FESCUE
  - ELYMUS CANADENSIS, CANADA WILD RYE
  - HELIOPSIS HELIANTHOIDES, OX EYE SUNFLOWER
  - PACHYSANDRA TERMINALIS, PACHYSANDRA
- SHRUBS
- ILEX GLABRA, INKBERRY
  - ILEX VERTICILLATA, WINTERBERRY HOLLY
  - MYRICA PENSYLVANICA, NORTHERN BAYBERRY
  - CLETHRA ALNIFOLIA, SWEET PEPPERBUSH
  - AESCULUS PARVIFLORA, BOTTLEBRUSH BUCKEYE
- SMALL TREES
- AMELANCHIER CANADENSIS, SERVICEBERRY
  - CORNUS FLORIDA, FLOWERING DOGWOOD
  - MALUS ‘ADIRONDACK’, CRABAPPLE
- MEDIUM TREES - ACER NEGUNDO, BOX ELDER
- LARGE TREES
- GYMNOCLADUS DIOICUS, KENTUCKY COFFEE TREE
  - QUERCUS ALBA, WHITE OAK
  - BETULA NIGRA, RIVER BIRCH

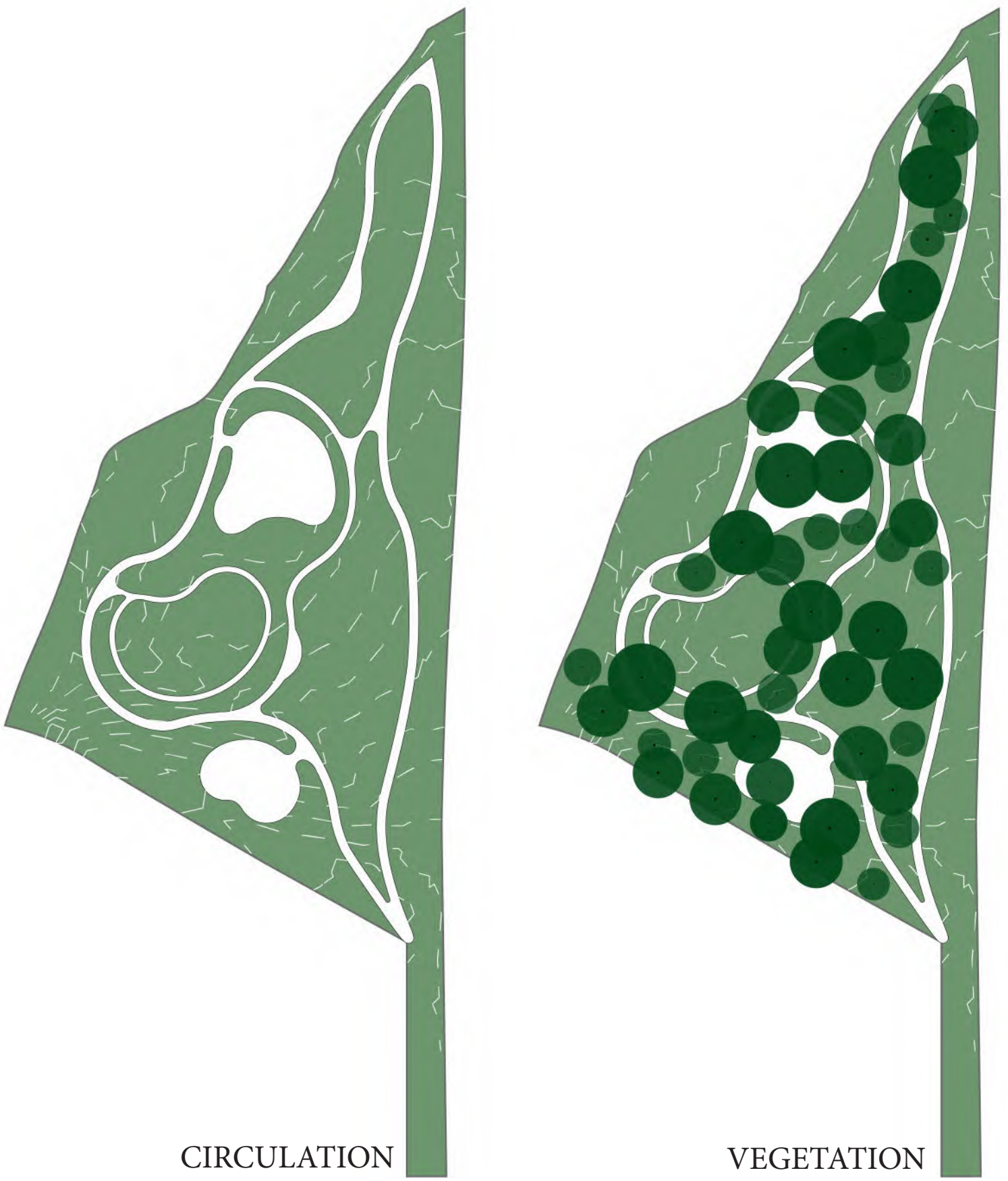

INDIAN LAKE: RECONNECTING WITH NATURE

BY AMBER RACHELE & SARAH DAUBE

LANDARCH397A FALL 2022

CONCEPT STATEMENT: INVOLVE THE PUBLIC IN AN EDUCATIONAL, INCLUSIVE, AND INTERACTIVE SPACE, WHICH IS ACCESSIBLE TO ALL COMMUNITY MEMBERS AND RESIDENTS OF WORCESTER; TO CONNECT THE COMMUNITY TO NATURE



Boylston Park:  
A Functional Community  
Gathering Expanse

- 1. Playground
- 2. Paved Seating Area
- 3. Great Lawn
- 4. Orchard
- 5. Boardwalk/ Launch
- 6. Mural Wall

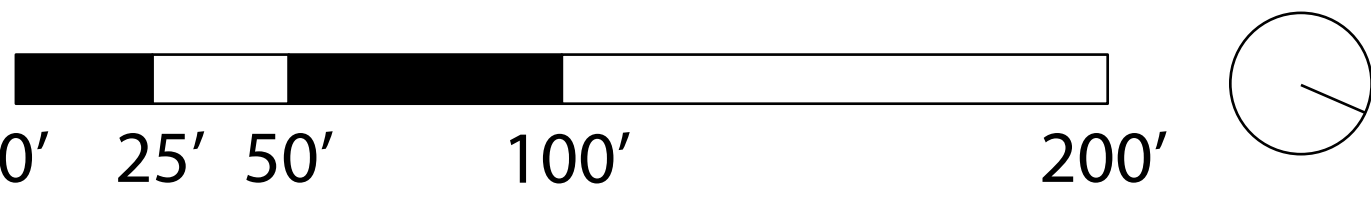



Indian Lake Park Site Plan





KEY

- 1 PIER DECK
- 2 GENERAL PLAZA
- 3 PLAYGROUND AREA
- 4 COMMUNITY GARDEN
- 5 LAWN
- 6 RAIN GARDEN DEPRESSION
- 7 BRIDGE PLAZA



SITE PLAN

